



ZIPPITY

Easy Does It!

BURBANK

VINYL GATE KIT
(41"H X 59½"W)

ASSEMBLY INSTRUCTIONS

ZP19071

60 MIN

Approximate assembly time

Want to see a video on how to
assemble this product?
Scan the QR code

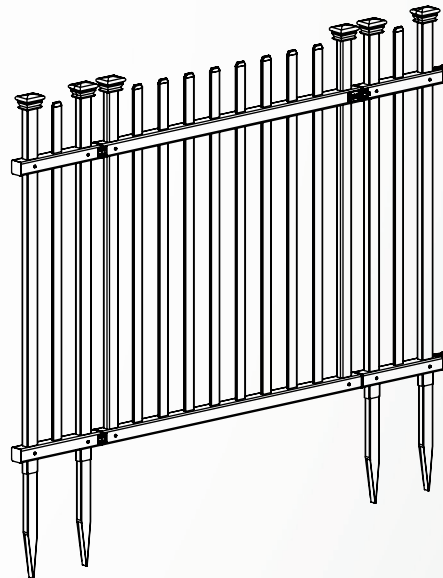

GENERAL INFORMATION



IMPORTANT

- + Check the inside of the larger pieces in your box for other materials packed inside.
- + When assembling components, place on a non-abrasive surface (i.e. shipping box) to avoid scratching.
- + We recommend an area approximately 5'x 8' for unobstructed assembling.
- + You should not need to use excessive force when assembling components.

MISSING OR DAMAGED PARTS?

VISIT OUR WEBSITE FIRST, SO WE CAN HELP YOU RIGHT AWAY!

Although great care has been taken to ensure proper packaging and handling of this product, occasionally problems occur. If you discover any missing, damaged, or defective parts, please visit our website to order replacement parts. If you experience any further trouble with your product, please contact our customer service department.

 parts.nychbrands.com

 support@zippity-outdoor.com

 **704-892-5222 / 877-234-6196**

Customer service agents are available to take calls weekdays from 9am-5pm EST. If you call outside of business hours, please leave a voicemail.

To help you quickly and accurately, please have reference item number **ZP19071** and the specific part name which can be found on page 4. It is helpful if you can provide the batch lot which is a stamped number inside the box.

NEED ASSEMBLY HELP?

If you are having problems with the assembly or installation of this product, we are happy to assist you with the process, **so please give us a call at 704-892-5222 / 877-234-6196.**

NEED TO RETURN?

If for some reason you need to return this product, please allow us to help resolve your issues first. If you still decide to return the product, **you will need to initiate the return from the company you originally purchased from.**

Detailed Product Dimensions & Specifications

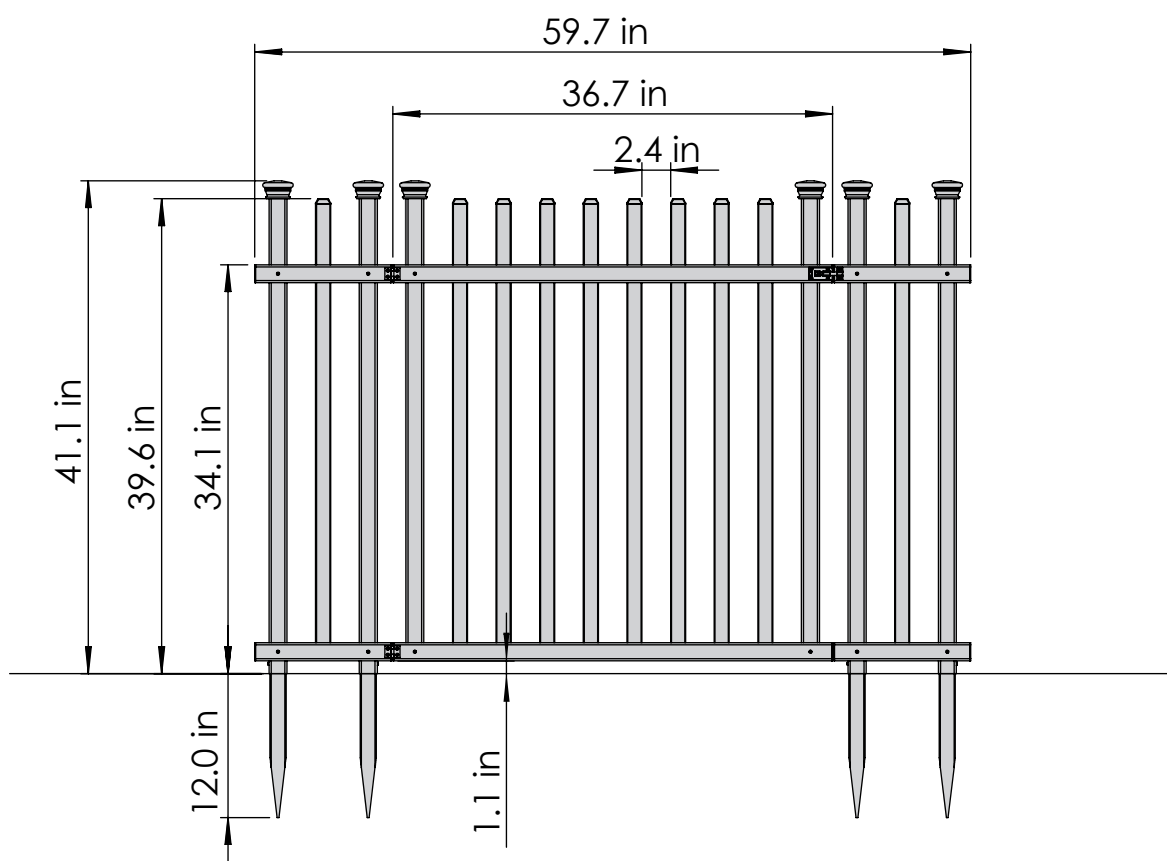

STEP 1: LAY OUT MATERIALS

STEP 1.1 ►

► Check the inside of the larger pieces in your box for other materials packed inside.

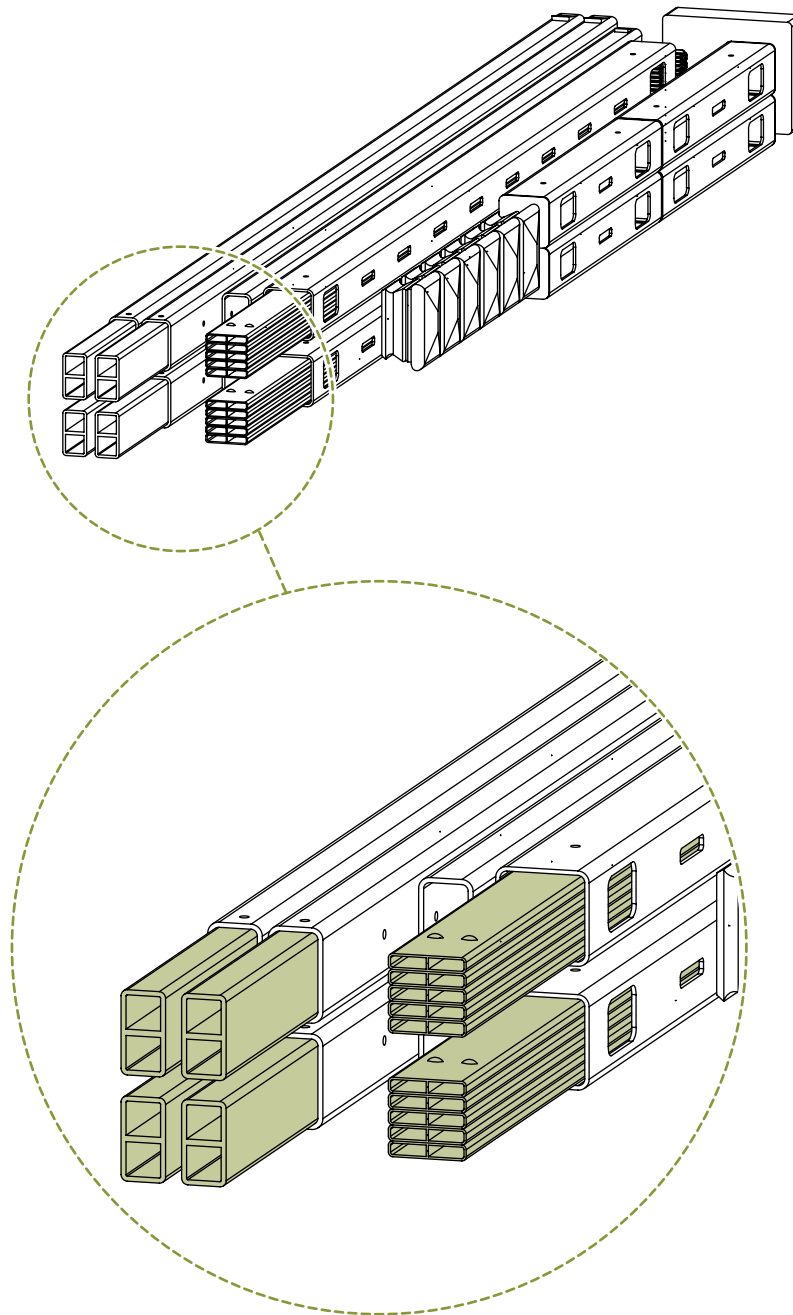

STEP 2: LAY OUT MATERIALS

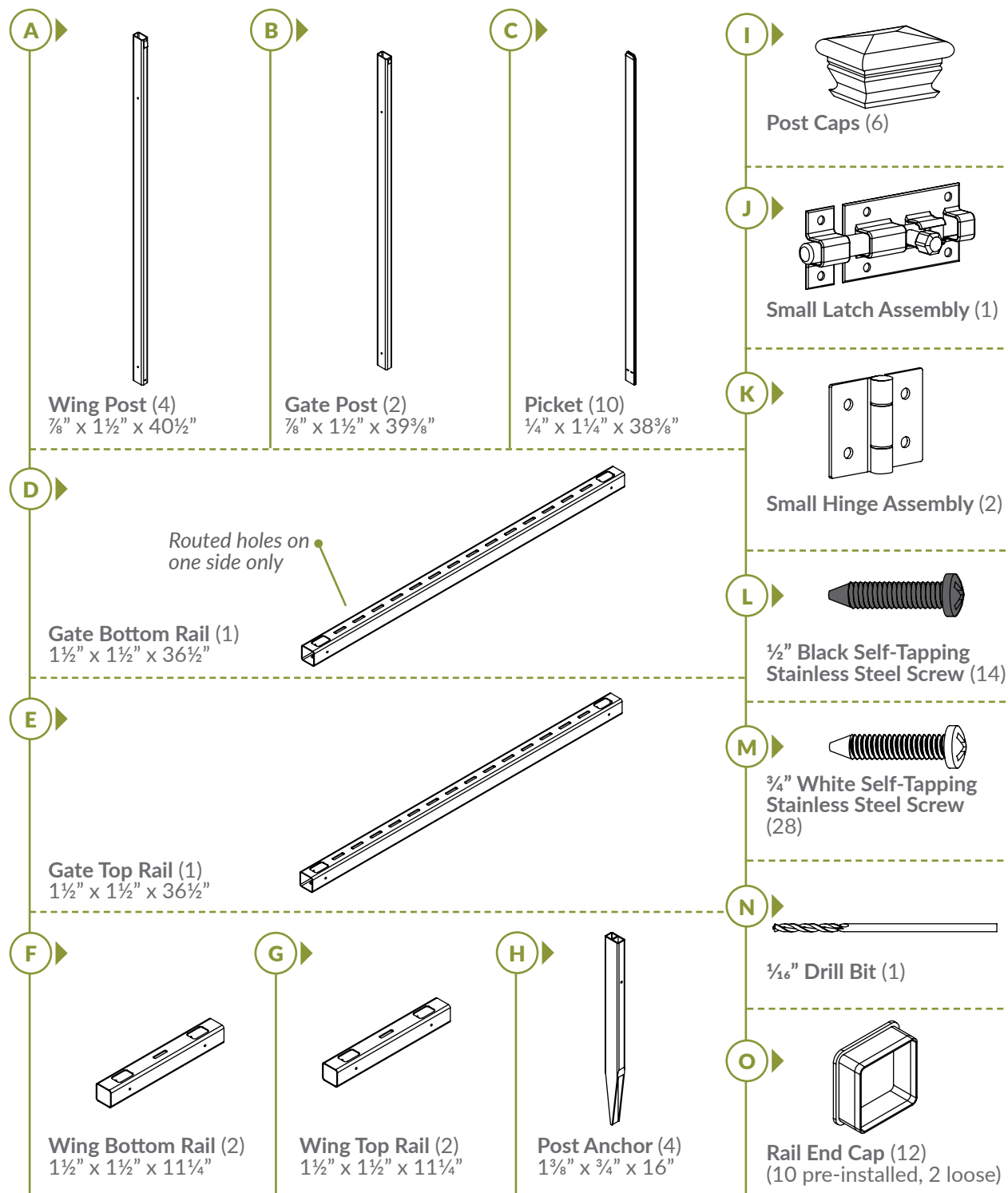

STEP 3: ASSEMBLE THE GATE WINGS

STEP 3.1 ▶

1. Slide (2) Wing Posts (A) down through the routed holes in the Wing Top Rail (G) until the pre drilled holes in the wing posts and rail align.
2. Drive (4) total ¾" White Self-Tapping Stainless Steel Screws (M) through the pre drilled holes in the wing top rail.

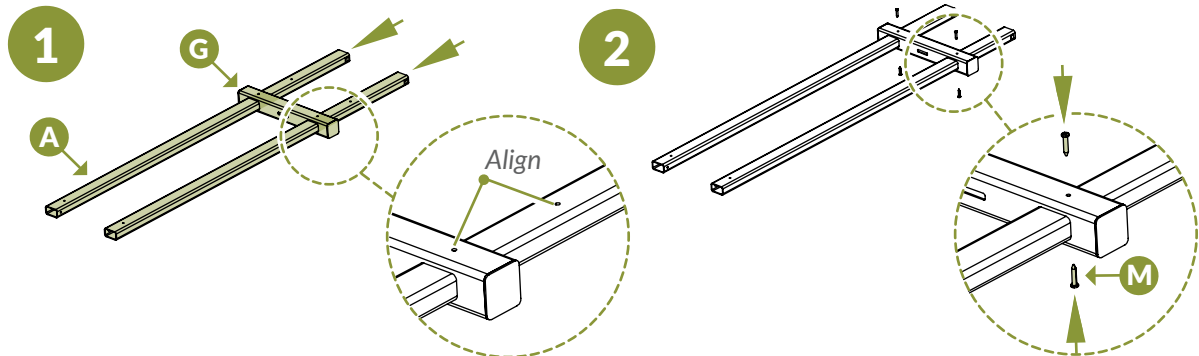

STEP 3.2 ▶

1. Slide the Wing Bottom Rail (F) up the wing posts until the pre drilled holes in the bottom of the wing posts and the rail align.
2. Keeping the pre drilled holes aligned, slide the Post Anchors (H) up into the wing posts until the pre drilled holes in the post anchors and bottom of the wing posts align. Drive (2) ¾" white self-tapping stainless steel screws to temporarily secure the post anchors.

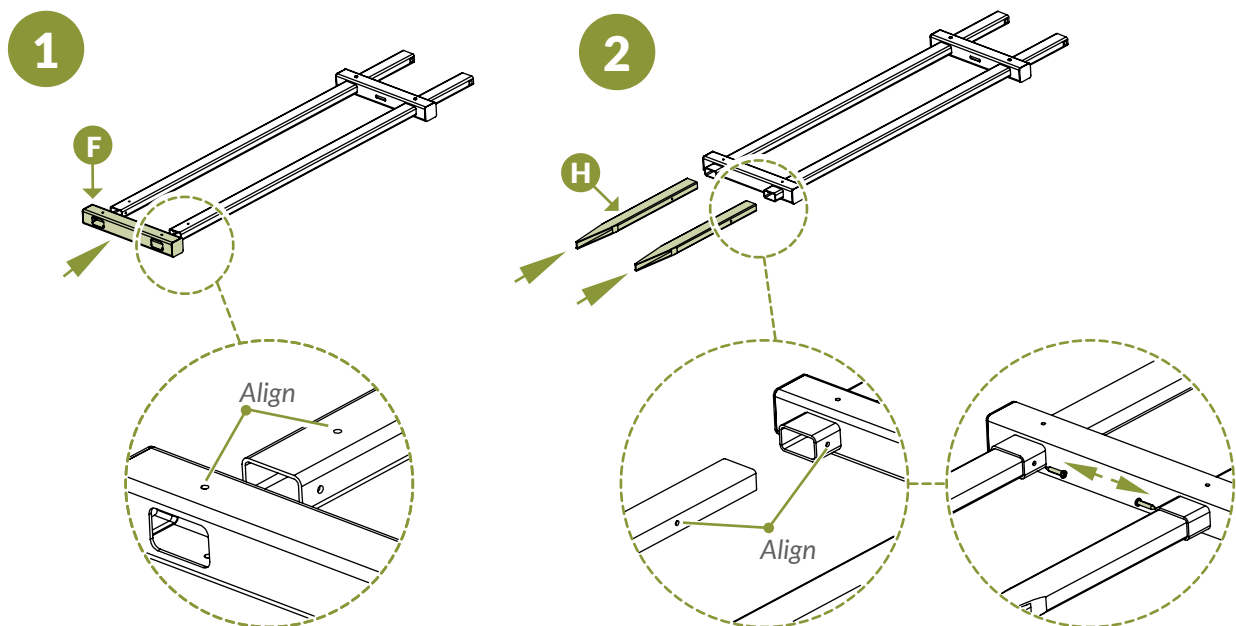

STEP 3.3

1. Use the $\frac{1}{16}$ " Drill Bit (N) to pre drill holes in the post anchor through the pre drilled holes in the wing bottom rail.
2. Drive (4) $\frac{3}{4}$ " white self-tapping stainless steel screws through the pre drilled holes in the wing bottom rail.

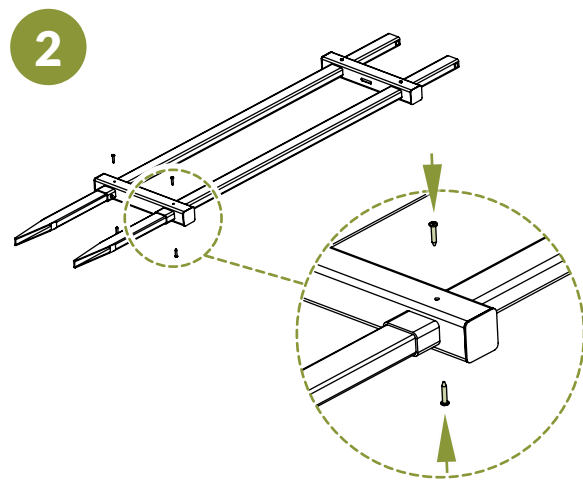
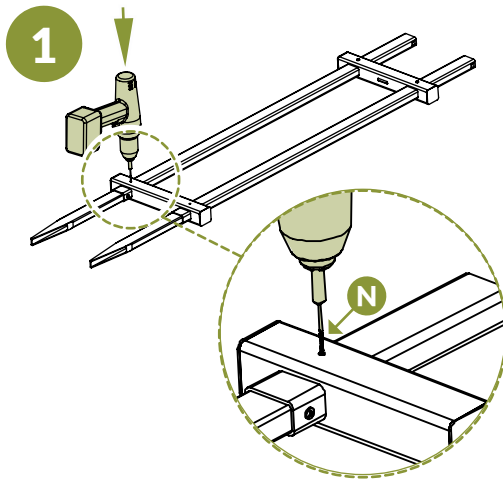
**STEP 4: ASSEMBLE THE GATE FRAME****STEP 4.1**

1. Slide (1) Gate Top Rail (E) over the bottom of the Gate Posts (B) until the pre-drilled holes in the gate top rail and top of gate posts align. Slide (1) Gate Bottom Rail (D) over the bottom of the gate posts until the pre-drilled holes in the gate bottom rail and bottom of gate posts align.
2. Drive (7) total $\frac{3}{4}$ " white self-tapping stainless steel screws through the pre-drilled holes in the rails. One screw will be left off the top right of the frame for future latch installation.

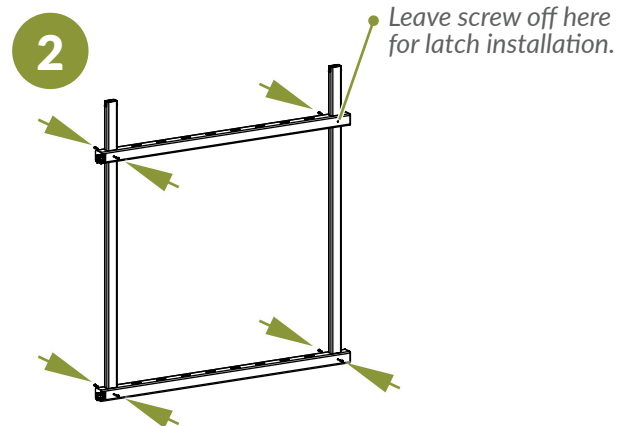
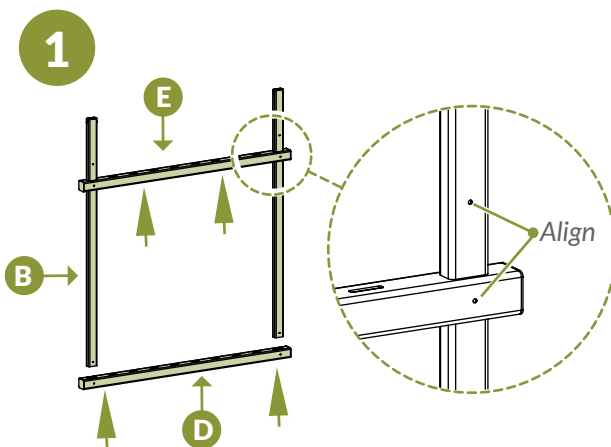

STEP 4.2 ▶

1. Insert (8) Pickets (C) into the gate rails until the tabs lock in the gate bottom rail.
2. Insert (2) Post Caps (I) over the tops of the gate posts.
3. Insert (2) Rail End Caps (O) over the ends of the gate rails.

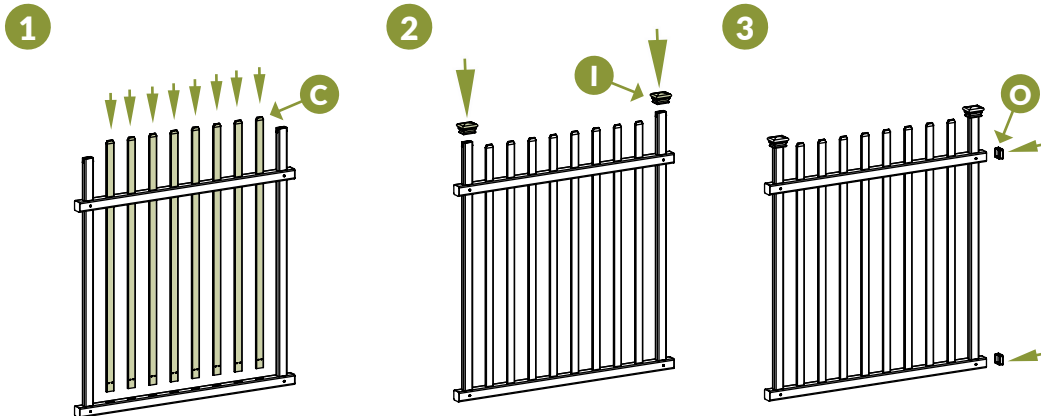
**STEP 5: ASSEMBLE THE GATE WINGS****STEP 5.1** ▶

1. Place (2) Hinges (K) against the gate rails and drill two holes per hinge through the pre drilled holes in the hinges.
2. Drive (4) total ½" Black Self-Tapping Stainless Steel Screws (L) through the holes in the hinges.

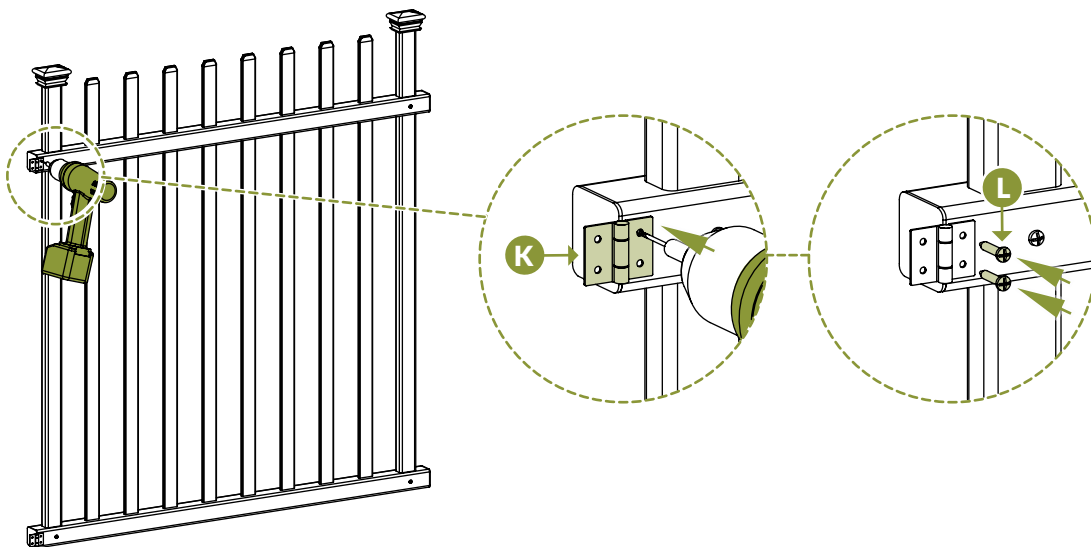

STEP 5.2 ▶

1. Place (1) Latch (J) against the gate top rail and drill four holes through the pre drilled holes in the latch body.
2. Drive (4) total $\frac{1}{2}$ " black self-tapping stainless steel screws through the holes in the latch body.

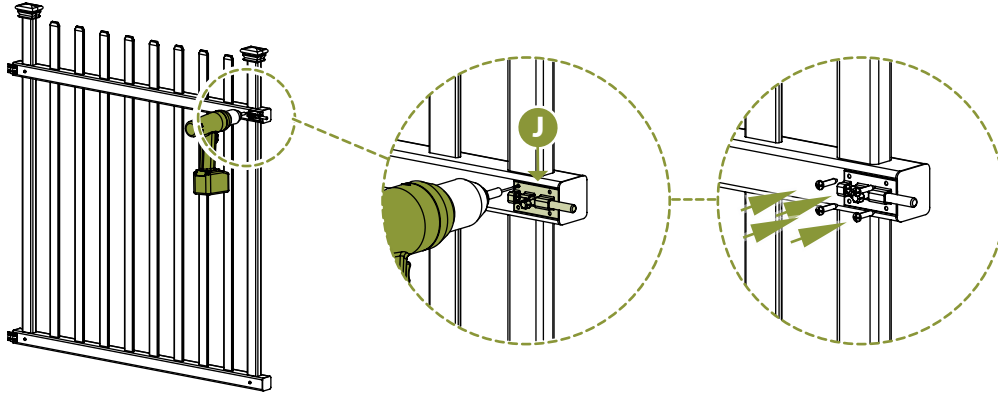
**STEP 6: INSTALL GATE WINGS INTO THE GROUND****STEP 6.1** ▶

▶ Move the gate wings to their final location and mark the location of the wing posts. The wing posts should be $36\frac{3}{4}$ " apart from rail end cap to rail end cap or $39\frac{1}{4}$ " from outside of wing post to outside of wing post.

Note: It is recommended to use two people for in-ground installation.

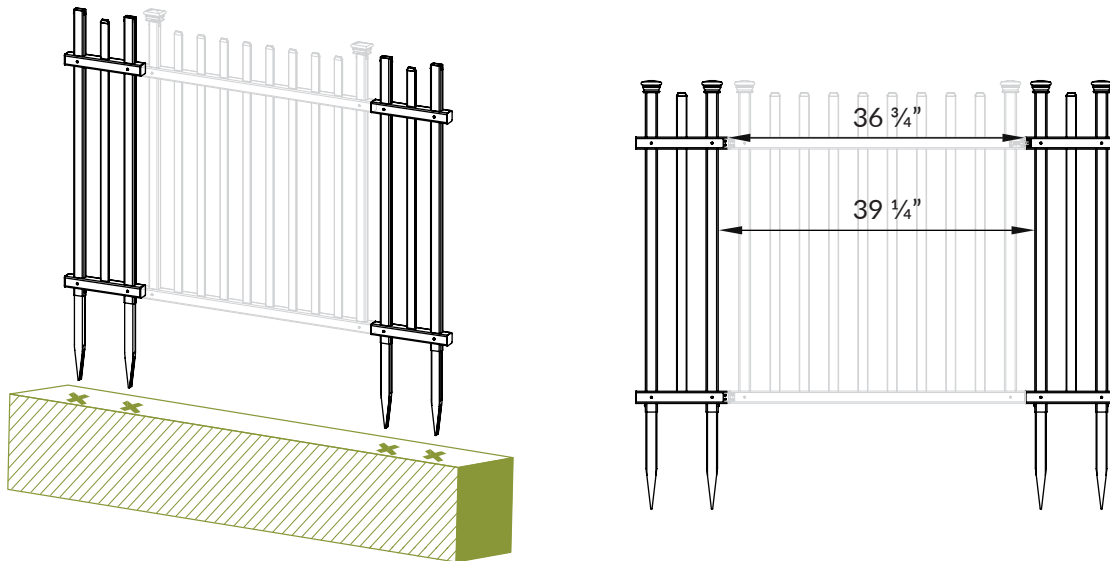

STEP 6.2 ▶

▶ Attempt to push the wing posts into the ground at the marked locations. If your ground is too hard, follow these steps illustrated below:

1. Loosen the top 6" to 8" of the ground using a claw hammer or similar tool.
2. Add water to soften the soil.
3. Use a block of wood to protect the top of the wing post and gently hammer each wing post into the ground until the bottom wing rails are roughly 1" above the ground.

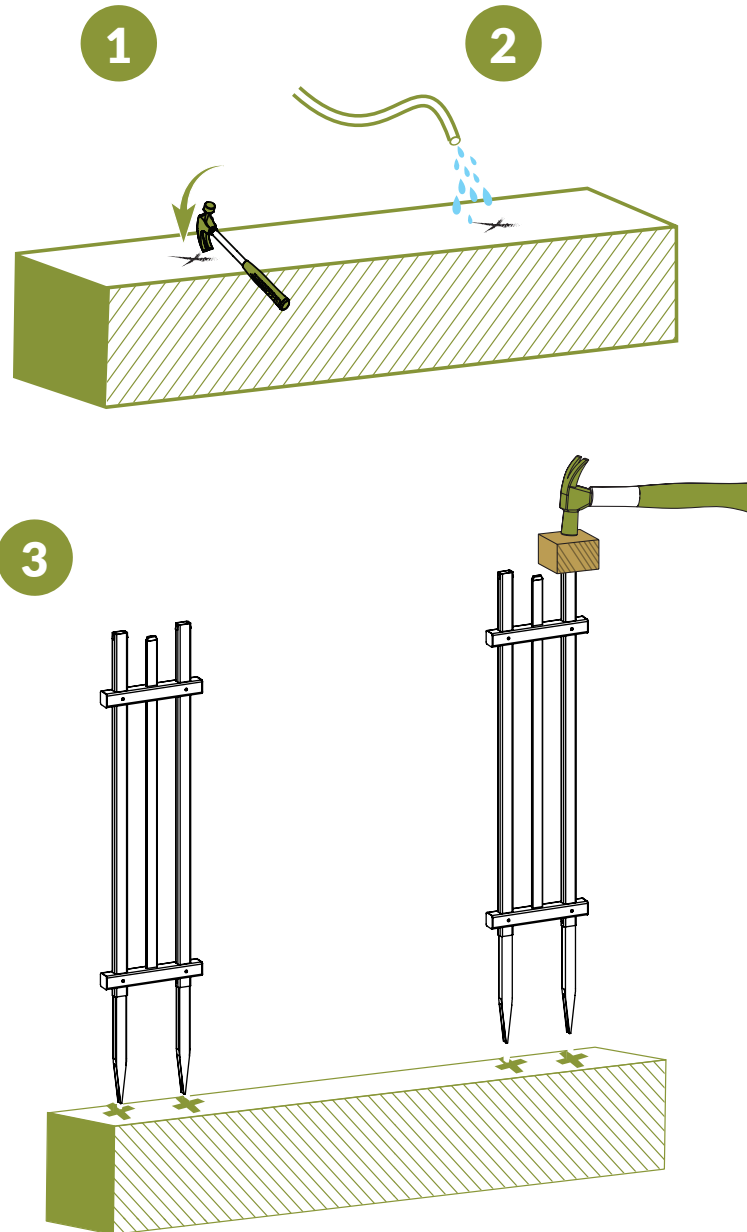

STEP 6.3 ▶

► **Optional in hard ground:** If your ground is too hard, please consider these options:

1. Use a 1¼" diameter auger bit (commonly used for planting tulips) as illustrated (\$15-\$20 on Amazon.com).
2. Drill a hole about 12" to 16" deep at the desired location, and fill the holes with water as illustrated.
3. Push the wing posts into the holes.

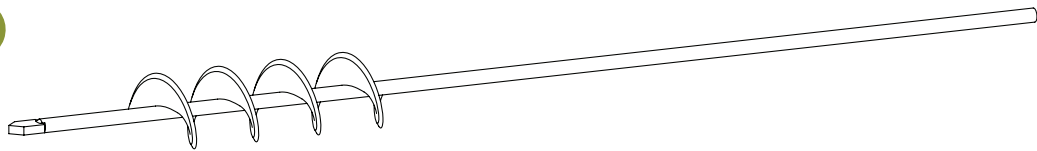
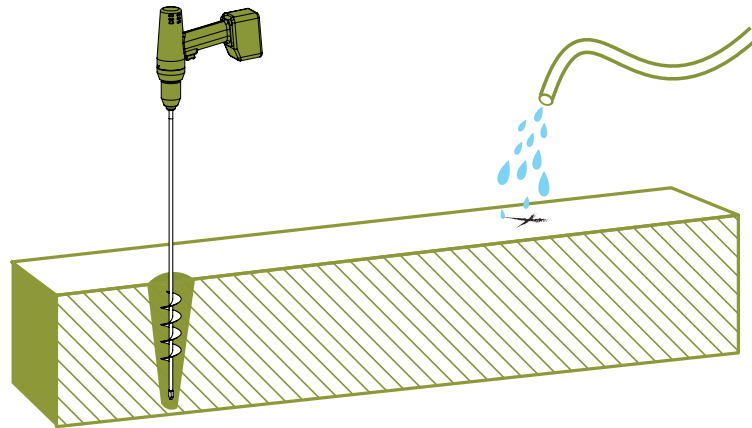
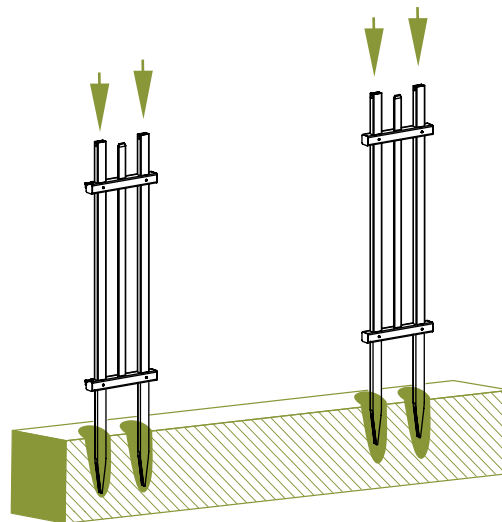
1**2****3**

STEP 6.4 ▶

- ▶ Level the assembled unit. Backfill and compact dirt around the base of each wing post to strengthen the unit.

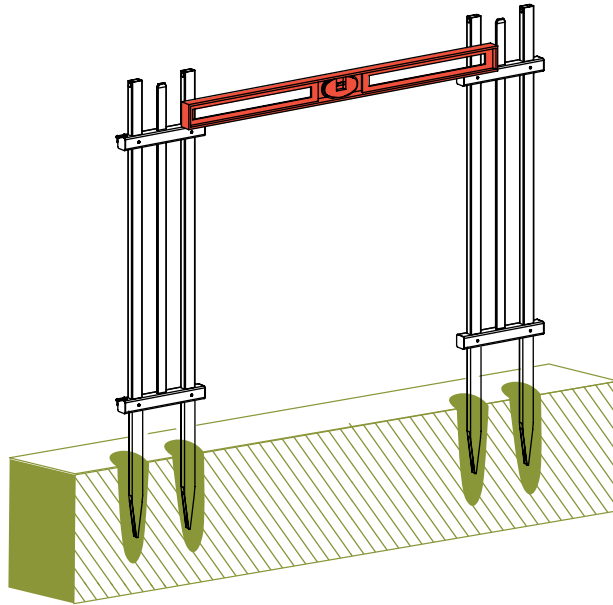
**STEP 6.5** ▶

- ▶ Push the post caps down over the tops of the wing posts as illustrated. The post caps will lock into place.

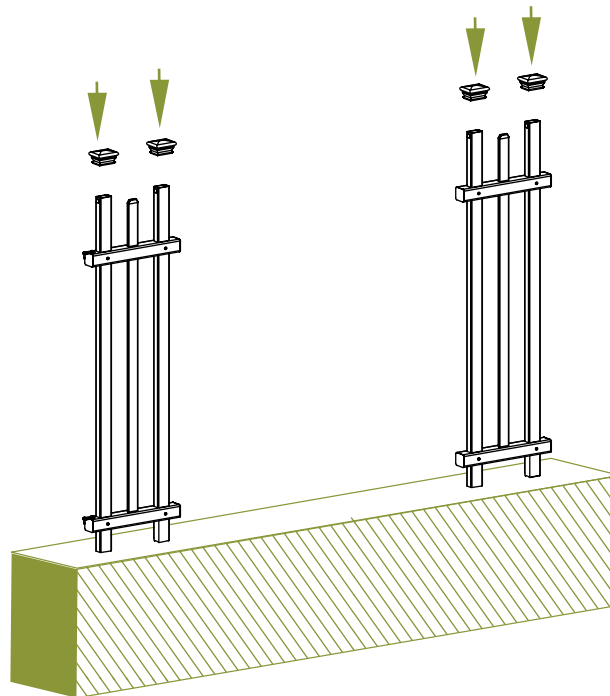

STEP 7: INSTALL THE GATE

STEP 7.1 ▶

▶ Align the gate hinges with the wing rails as illustrated. Mark and pre-drill two holes for each hinge with the $\frac{1}{16}$ " drill bit and fasten both hinges with (4) $\frac{1}{2}$ " black self-drilling stainless steel screws.

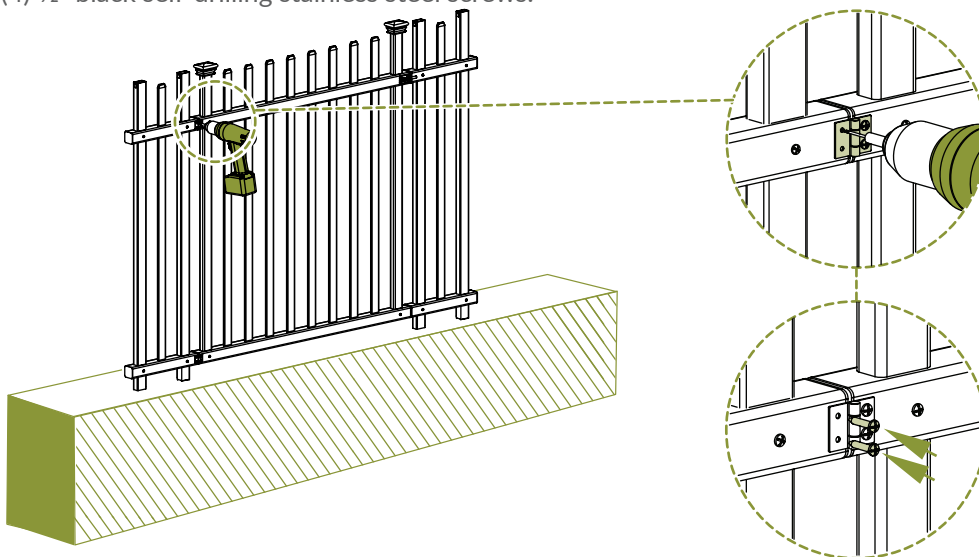

STEP 7.2 ▶

▶ Align the latch catch with the latch body and pre-drill two holes into the wing top rail of the gate wing. Fasten with (2) $\frac{1}{2}$ " black self-tapping stainless steel screws.

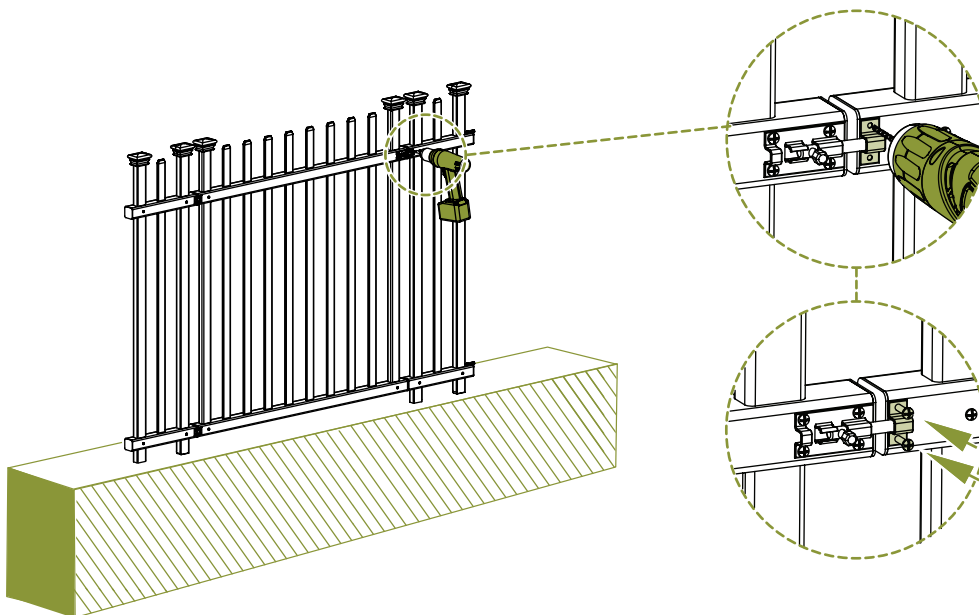

STEP 8: INSTALL THE FENCE PANELS

STEP 8.1 ▶

▶ Drive the $\frac{3}{4}$ " white self-tapping stainless steel screws and the joiner clips included with your Burbank Fence Kit (ZP19057) to connect the gate wings to the fence panels as shown below.

Note: It is not recommended to install this gate without connecting the wings to fence panels.

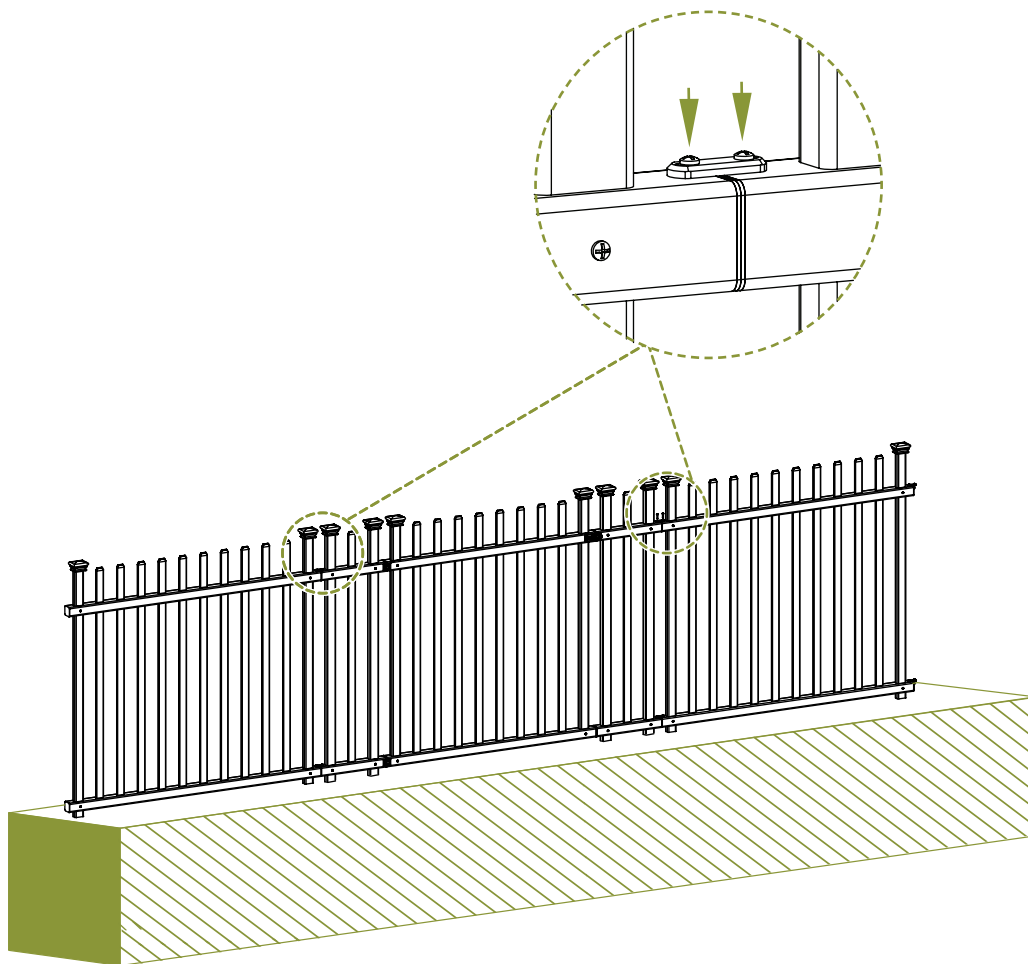



ZIPPITY

Easy Does It!



6935 Reames Rd. Ste. K.
Charlotte, NC 28216



support@zippity-outdoor.com

704-892-5222
877-234-6196



WWW.ZIPPITY-OUTDOOR.COM