



# ZIPPITY

*Easy Does It!*

## KENSINGTON HINGED PORTABLE FENCE KIT (65 ½" W X 38" H)

**30 MIN**

*Approximate assembly time*

Want to see a video on how to  
assemble this product?  
**Scan the QR code**



## ASSEMBLY INSTRUCTIONS ZP19069

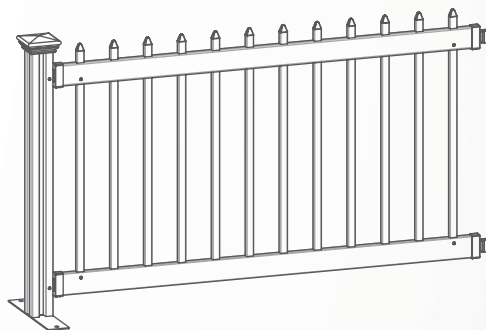

## GENERAL INFORMATION



### IMPORTANT

- + Check the inside of the larger pieces in your box for other materials packed inside.
- + When assembling components, place on a non-abrasive surface (i.e. shipping box) to avoid scratching.
- + We recommend an area approximately 5'x 8' for unobstructed assembling.
- + You should not need to use excessive force when assembling components.

## MISSING OR DAMAGED PARTS?

### VISIT OUR WEBSITE FIRST, SO WE CAN HELP YOU RIGHT AWAY!

Although great care has been taken to ensure proper packaging and handling of this product, occasionally problems occur. If you discover any missing, damaged, or defective parts, please visit our website to order replacement parts. If you experience any further trouble with your product, please contact our customer service department.

 [parts.nychbrands.com](http://parts.nychbrands.com)

 [support@zippity-outdoor.com](mailto:support@zippity-outdoor.com)

 **704-892-5222 / 877-234-6196**

*Customer service agents are available to take calls weekdays from 9am-5pm EST. If you call outside of business hours, please leave a voicemail.*

To help you quickly and accurately, please have reference item number **ZP19069** and the specific part name which can be found on page 4. It is helpful if you can provide the batch lot which is a stamped number on the end of the box.

## NEED ASSEMBLY HELP?

If you are having problems with the assembly or installation of this product, we are happy to assist you with the process, **so please give us a call at 704-892-5222 / 877-234-6196.**

## NEED TO RETURN?

If for some reason you need to return this product, please allow us to help resolve your issues first. If you still decide to return the product, **you will need to initiate the return from the company you originally purchased from.**

## Detailed Product Dimensions & Specifications

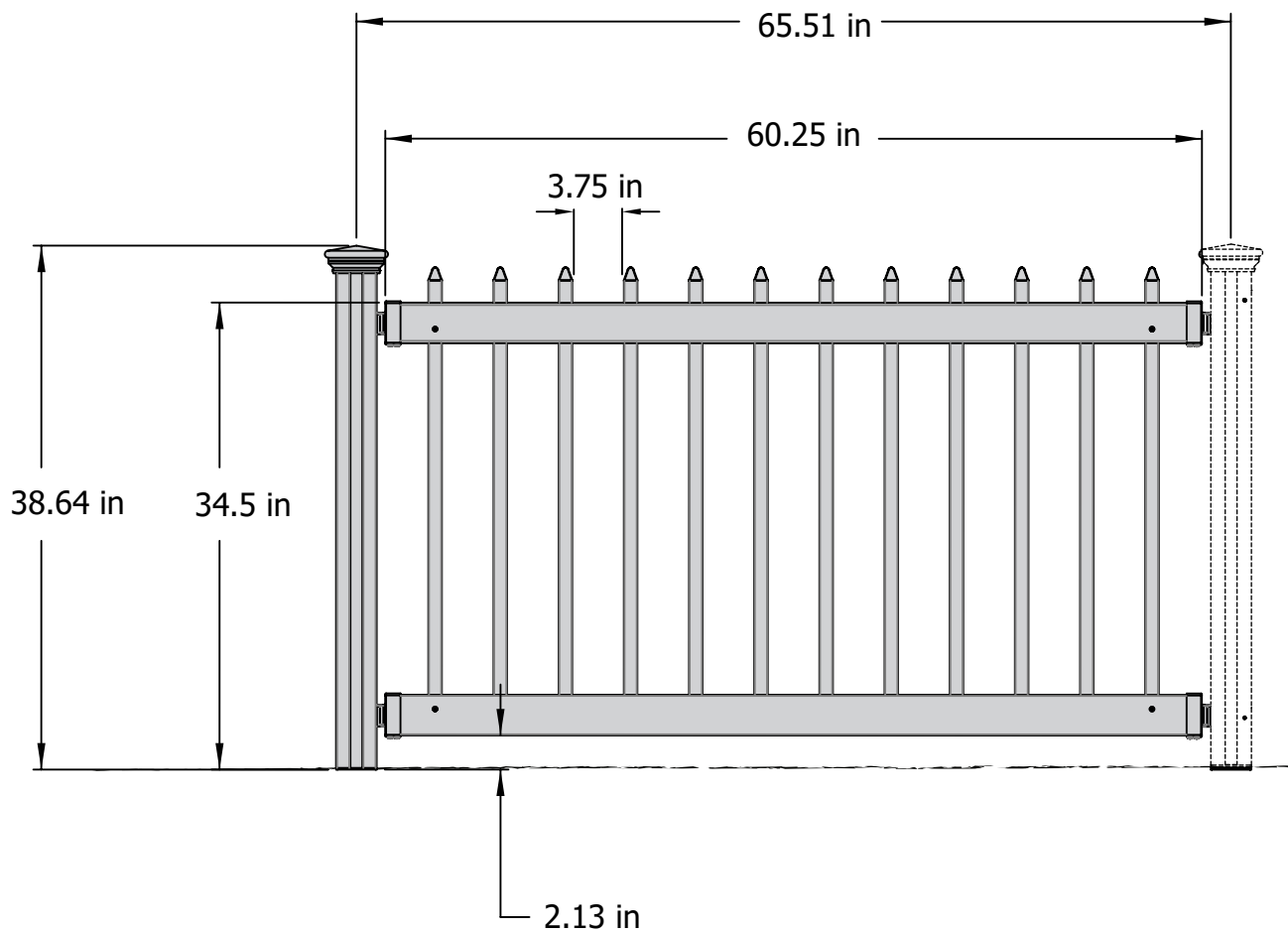

## STEP 1: LAY OUT MATERIALS

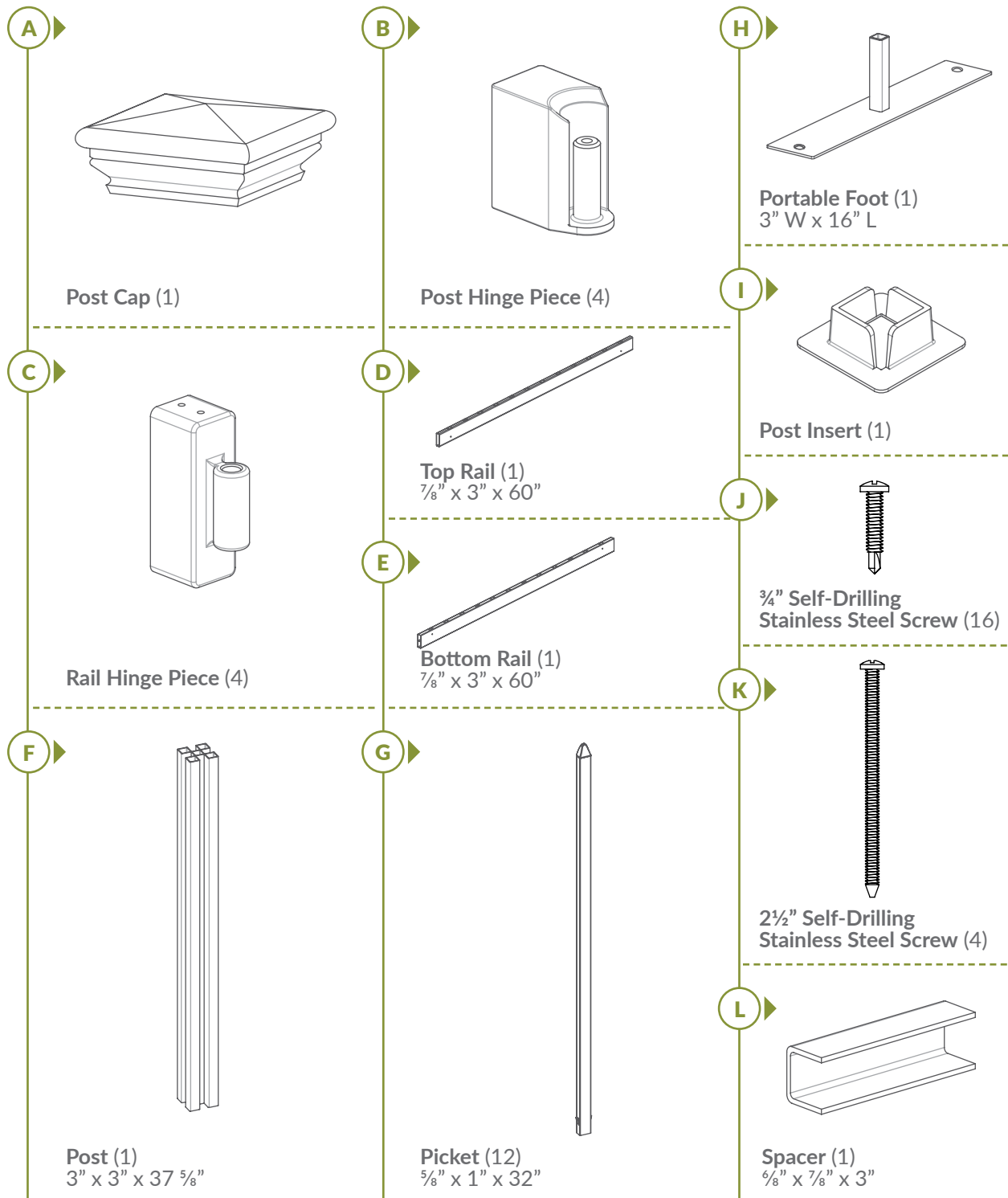

## STEP 2: ASSEMBLE FENCE PANEL

### STEP 2.1 ▶

1. Insert (12) Pickets (G) into the Bottom Rail (E) until they bottom out inside the rail.
2. Insert the Top Rail (D) over the pickets.
3. Drive (8)  $\frac{3}{4}$ " Self-Drilling Stainless Steel Screws (J) through the pre-drilled holes in the rails.

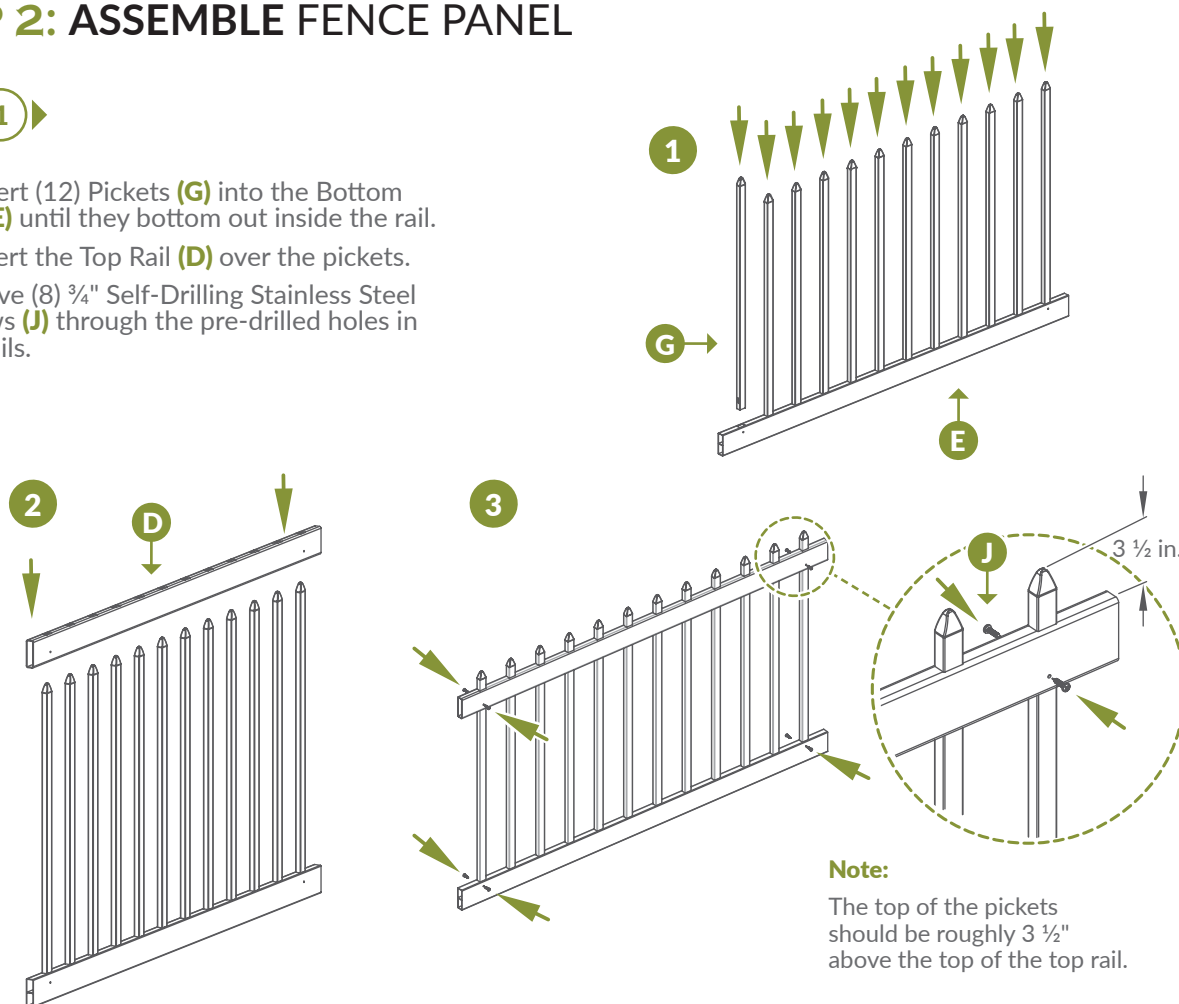

### STEP 2.2 ▶

1. Insert (4) total Rail Hinge Pieces (C) over the ends of the horizontal rails.
2. Drive (2)  $\frac{3}{4}$ " self-drilling stainless steel screws into the pre-drilled holes in each rail hinge piece.

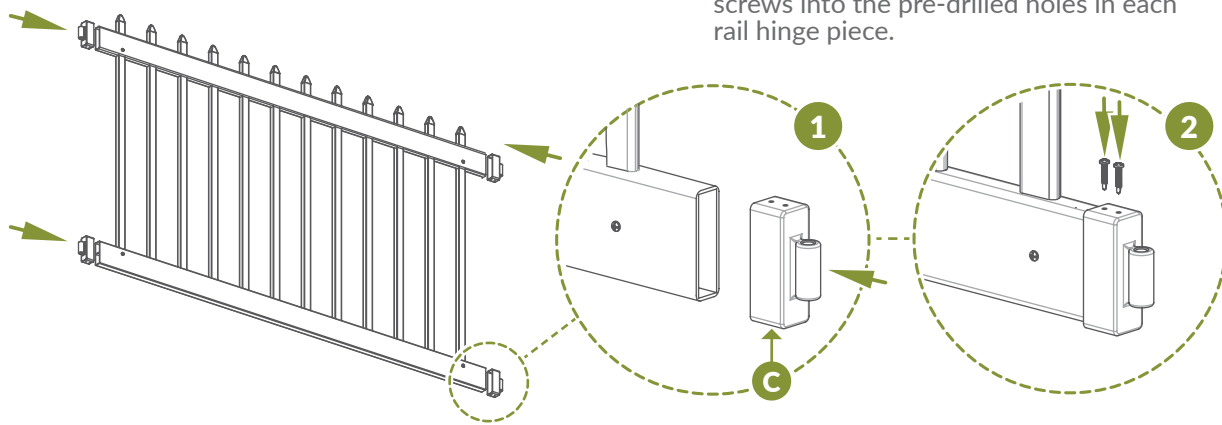

## STEP 3: INSTALL POST HINGE PIECES

### STEP 3.1 ▶

1. Insert (1) Post Hinge Piece (**B**) into the groove in the Post (**F**). Use the Spacer (**L**) to set the height of the hinge piece from the bottom of the post.
2. Ensure that the hinge peg is facing upward, and drive (1) 2 ½" Self-Drilling Stainless Steel Screw (**K**) into the edge of the post to secure the post hinge.

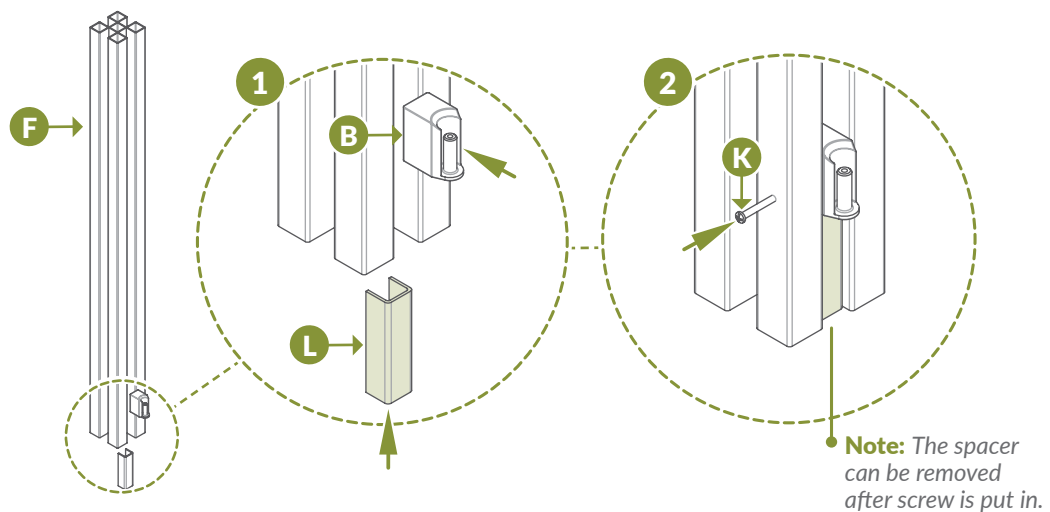

### STEP 3.2 ▶

- ▶ Insert the bottom rail hinge piece of the fence panel into the post hinge piece, and lay the joined post and fence panel on a flat surface.

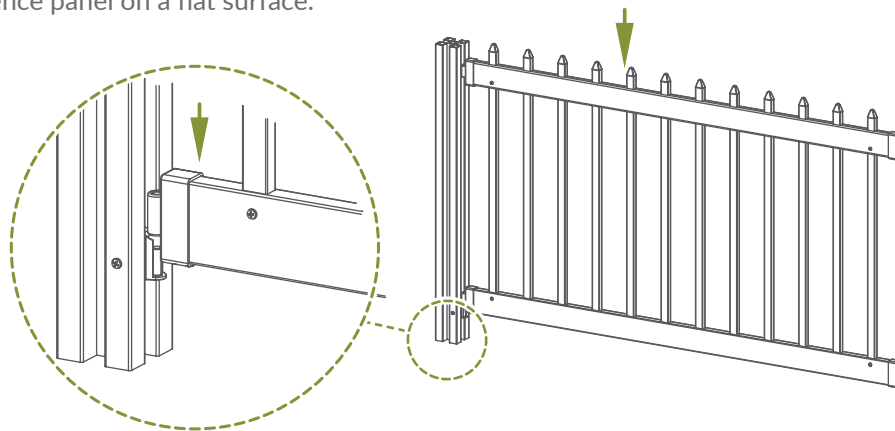

**STEP 3.3** ▶

1. Slide the remaining post hinge piece up the post channel to align with the top rail.
2. Drive (1) 2 ½" self-drilling stainless steel screw into the edge of the post to secure the post hinge.

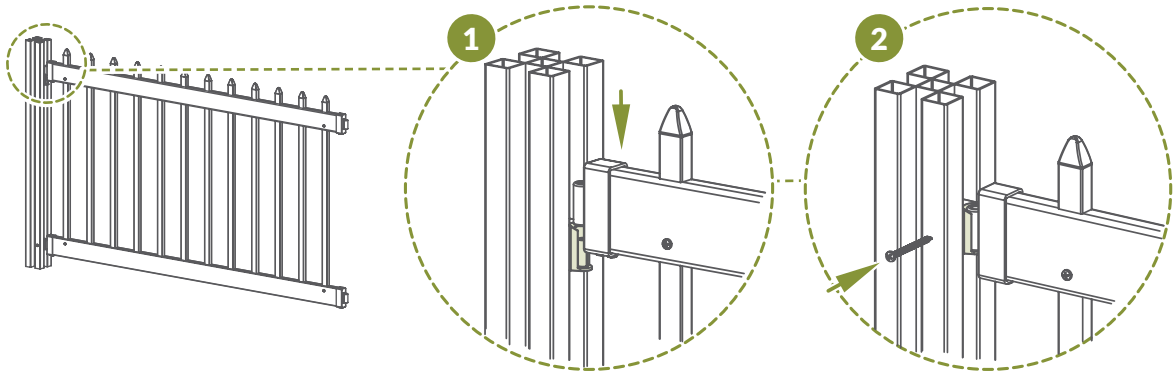
**STEP 3.4** ▶

- ▶ Repeat steps 3.1 through step 3.3 using the post from an additional panel, or the Hinged Portable Finishing Post (Item SKU: ZP19063) to end the run. Ensure that the spacer is used to achieve consistent hinge height.

**Note:** Please observe the best configuration for a 90° angle below.

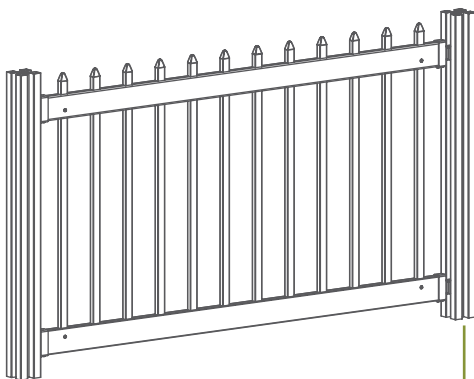

Additional post  
not included

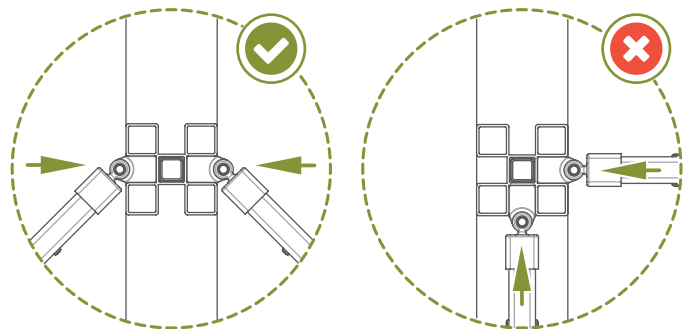

## STEP 4: INSTALL METAL FEET

### STEP 4.1 ▶

▶ Push the Post Insert (I) into the center cavity at the bottom of the posts.

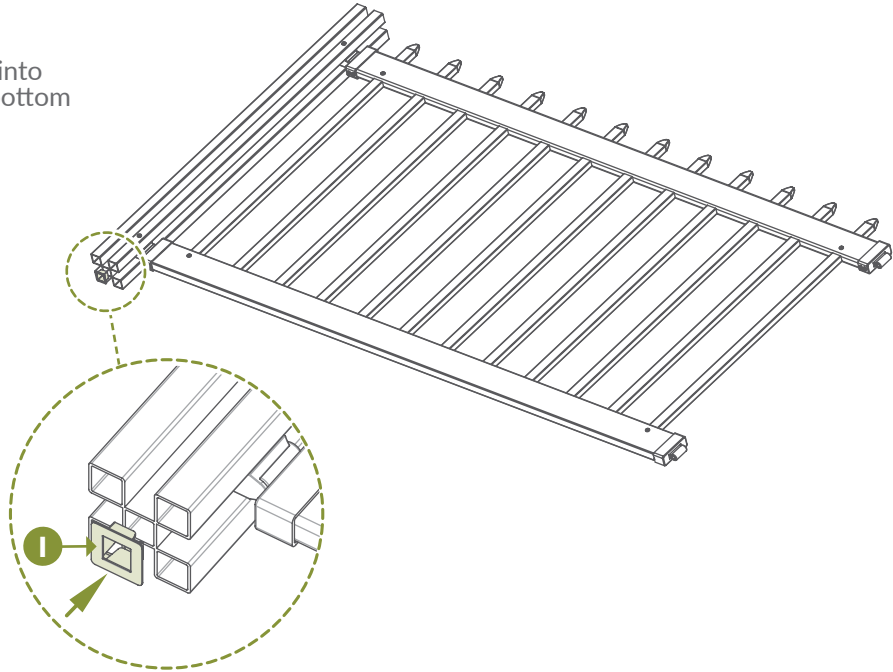

### STEP 4.2 ▶

▶ Insert the Portable Foot (H) into the center cavity at the bottom of the post.

**Note:** Inserting the portable feet may require some light force. Portable feet can be removed for storage.

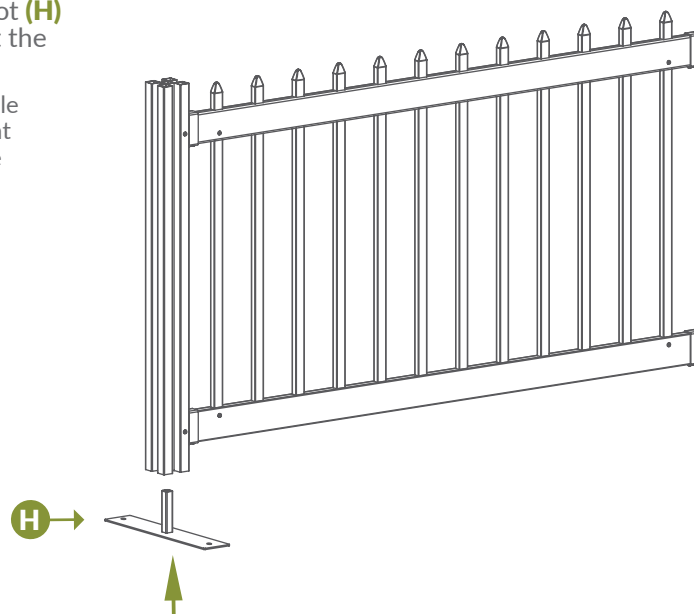



## STEP 5: INSTALL POST CAPS

### STEP 5.1 ▶

1. Install the Post Cap (A) over the top of the post to complete the fence assembly.
2. Continue the fence run with any additional purchased panels. One finishing post will be required for the end of your fence run.

**Note:** Purchase the Hinged Portable Finishing Post (Item SKU: ZP19063) to complete the fence run.

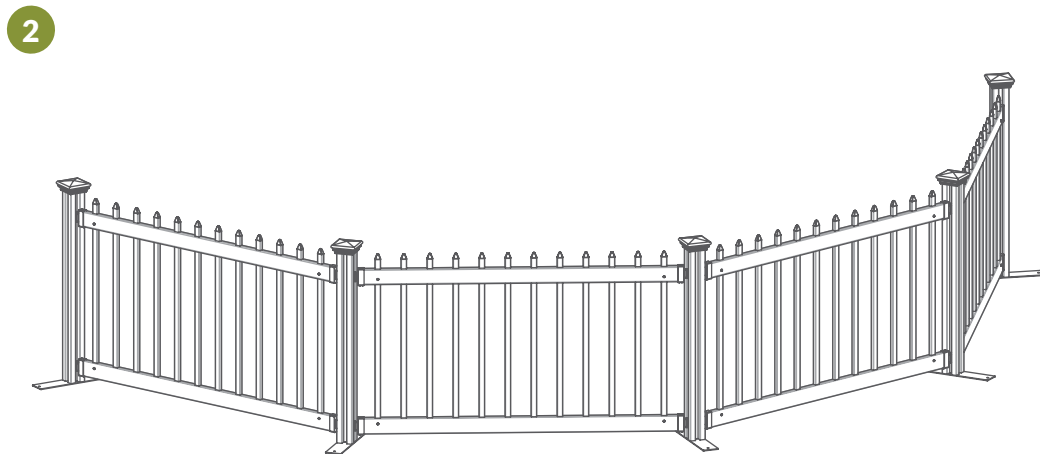
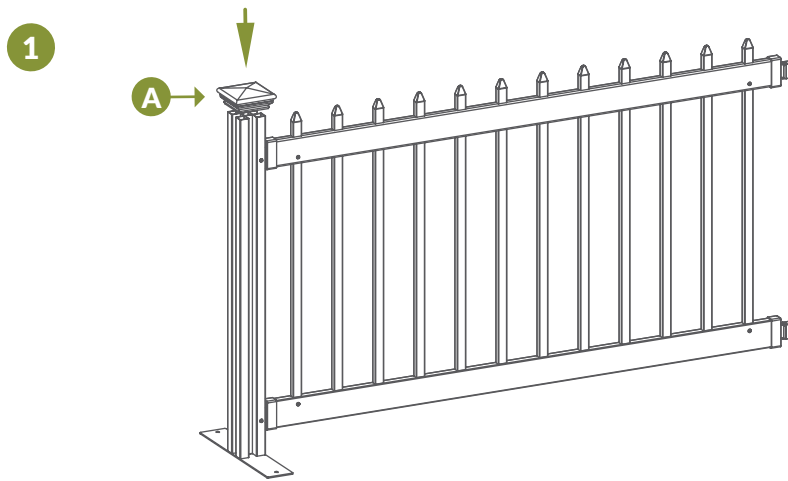

## STEP 6 (OPTIONAL): SECURE PORTABLE FEET

### STEP 6.1 ▶

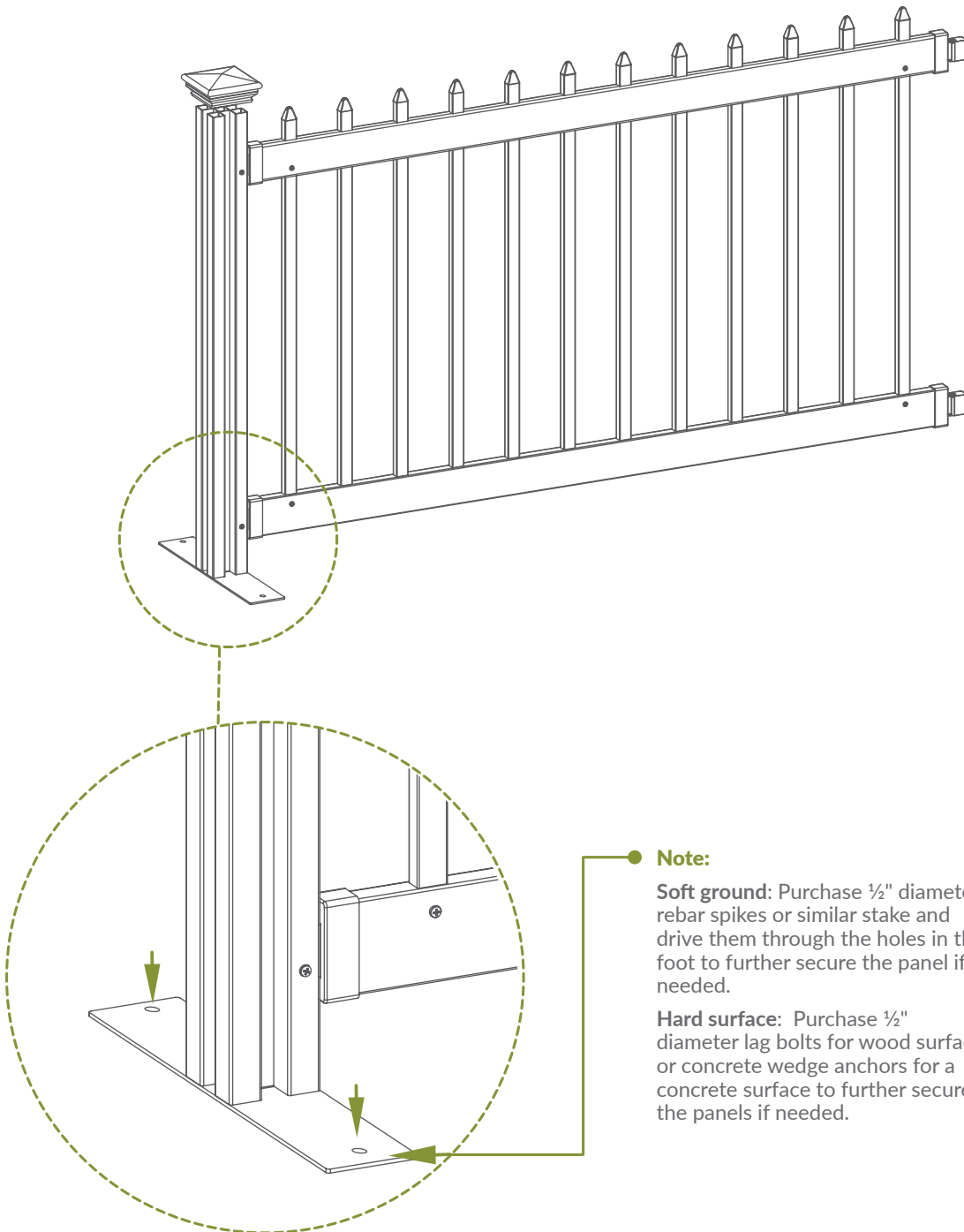
**Note:**

**Soft ground:** Purchase  $\frac{1}{2}$ " diameter rebar spikes or similar stake and drive them through the holes in the foot to further secure the panel if needed.

**Hard surface:** Purchase  $\frac{1}{2}$ " diameter lag bolts for wood surfaces or concrete wedge anchors for a concrete surface to further secure the panels if needed.

## STEP 7 (OPTIONAL): SECURE FENCE PANELS

### STEP 7.1 ▶

- ▶ Purchase a 2.5" screw and washer to drive into the post hinge as shown below to fix the panel to the posts.

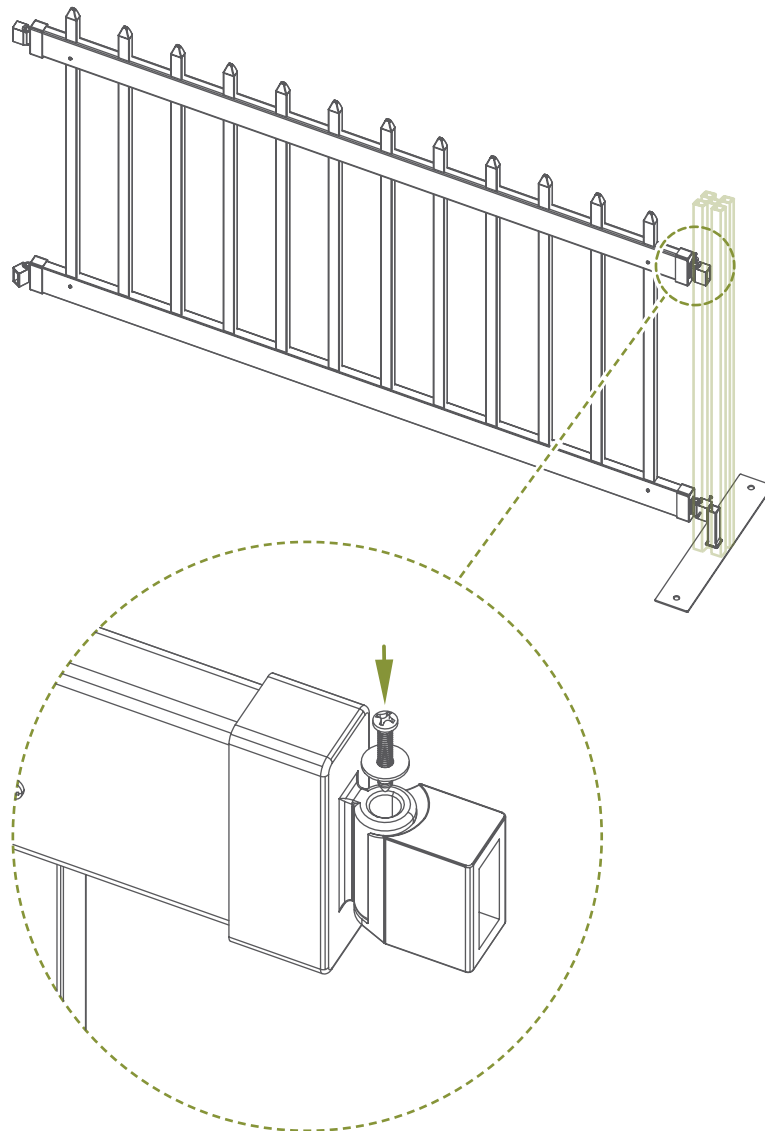



# ZIPPITY

*Easy Does It!*



6935 Reames Rd. Ste. K.  
Charlotte, NC 28216



[support@zippity-outdoor.com](mailto:support@zippity-outdoor.com)

704-892-5222  
877-234-6196



[WWW.ZIPPITY-OUTDOOR.COM](http://WWW.ZIPPITY-OUTDOOR.COM)