

ZIPPITY
Easy Does It!

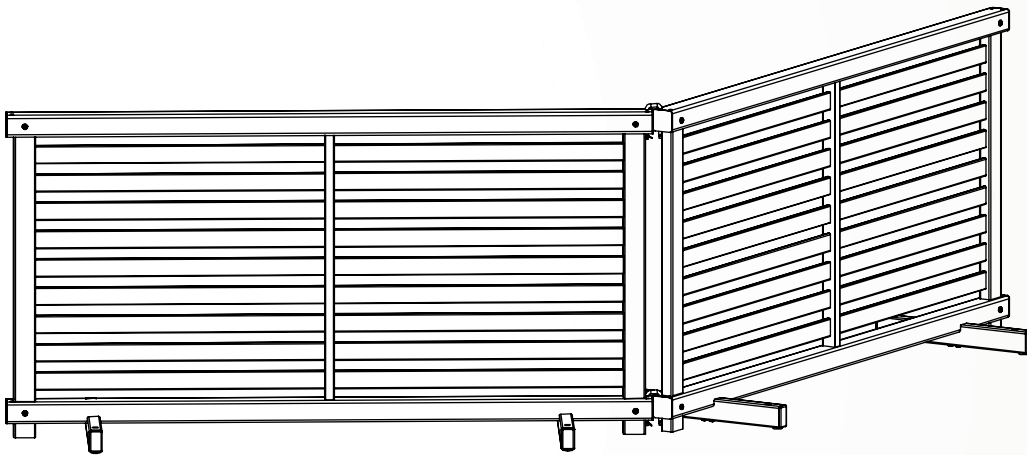

WOODTEK VINYL
SLATTED PORTABLE PUPPY
FENCE KIT 2-PACK
(44" W X 22³/₈" H)



ASSEMBLY INSTRUCTIONS

ZP19072 (CEDAR COLOR)
ZP19073 (CHARCOAL COLOR)

45 MIN

Approximate assembly time for 2 fence panels

Want to see a video on how to
assemble this product?

Scan the QR code

GENERAL INFORMATION



IMPORTANT

- + Check the inside of the larger pieces in your box for other materials packed inside.
- + When assembling components, place on a non-abrasive surface (i.e. shipping box) to avoid scratching.
- + We recommend an area approximately 5'x 8' for unobstructed assembling.
- + You should not need to use excessive force when assembling components.

MISSING OR DAMAGED PARTS?

VISIT OUR WEBSITE FIRST, SO WE CAN HELP YOU RIGHT AWAY!

Although great care has been taken to ensure proper packaging and handling of this product, occasionally problems occur. If you discover any missing, damaged, or defective parts, please visit our website to order replacement parts. If you experience any further trouble with your product, please contact our customer service department.

 parts.nychbrands.com

 support@zippity-outdoor.com

 **704-892-5222 / 877-234-6196**

Customer service agents are available to take calls weekdays from 9am-5pm EST. If you call outside of business hours, please leave a voicemail.

To help you quickly and accurately, please have reference item number **ZP19072/ZP19073** and the specific part name which can be found on page 5. It is helpful if you can provide the batch lot which is a stamped number inside the box.

NEED ASSEMBLY HELP?

If you are having problems with the assembly or installation of this product, we are happy to assist you with the process, **so please give us a call at 704-892-5222 / 877-234-6196.**

NEED TO RETURN?

If for some reason you need to return this product, please allow us to help resolve your issues first. If you still decide to return the product, **you will need to initiate the return from the company you originally purchased from.**

Detailed Product Dimensions & Specifications

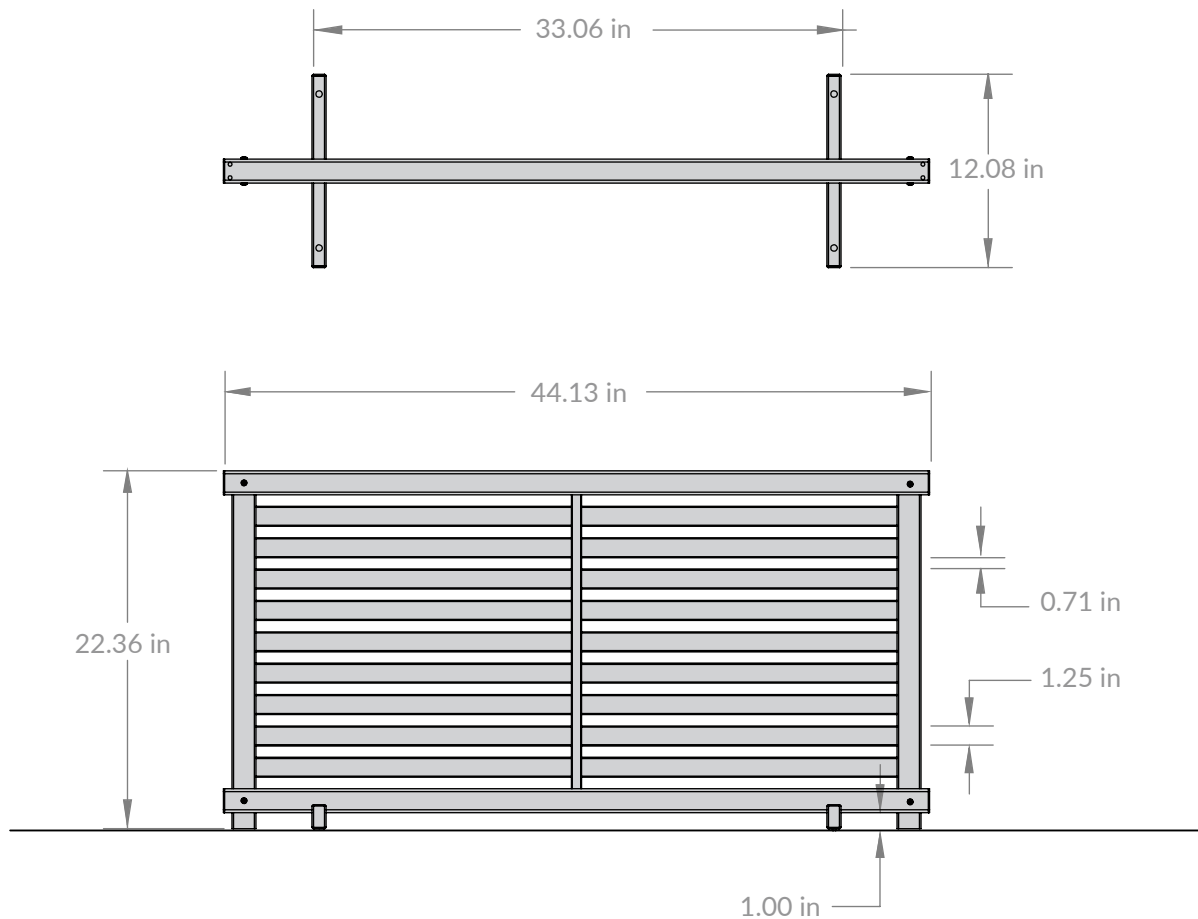

STEP 1: INSPECT PARTS

STEP 1.1 ▶

▶ Check the inside of the larger pieces in your box for other materials packed inside.

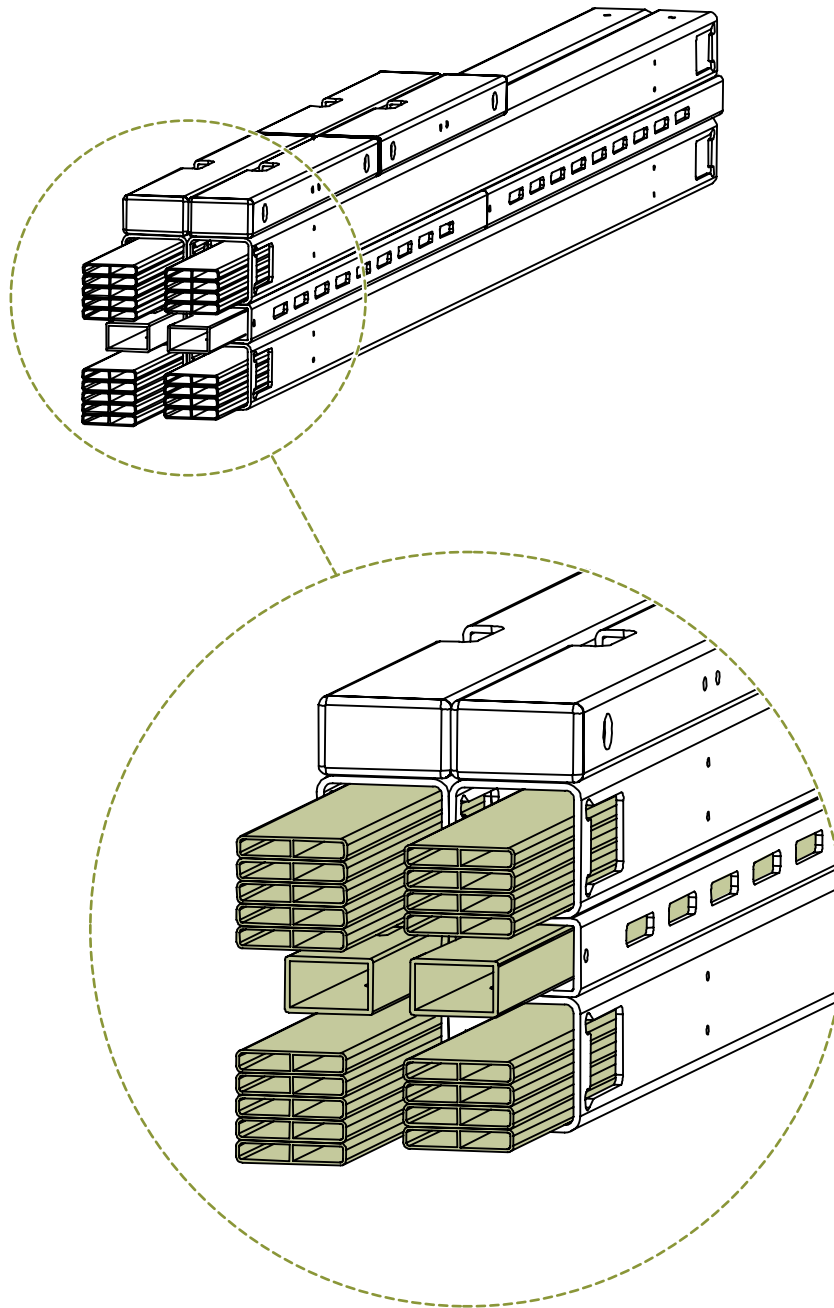

STEP 2: LAY OUT MATERIALS

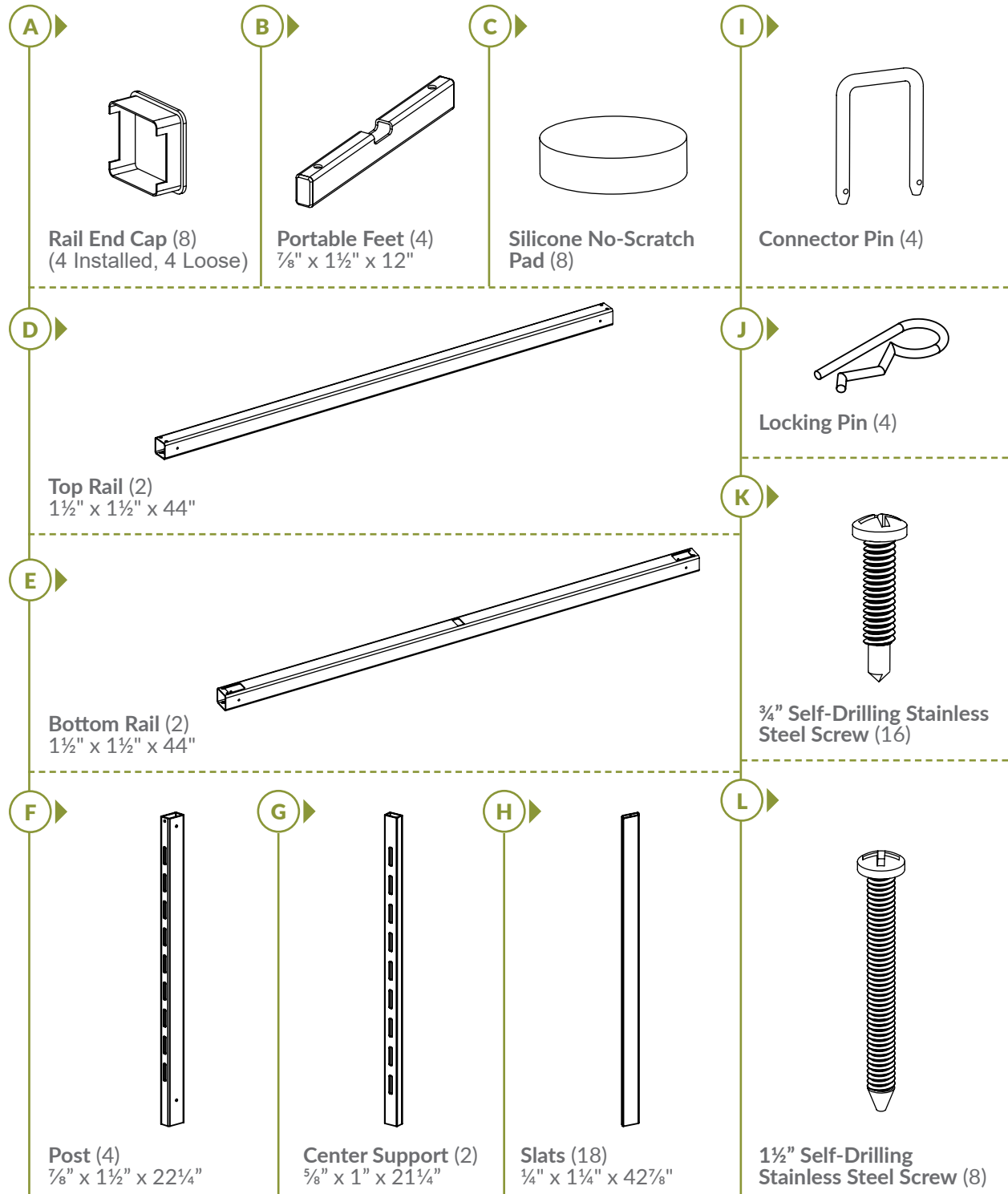

STEP 3: ASSEMBLE FIRST PANEL

STEP 3.1 ▶

- ▶ Slide (9) Slats (H) into the routed holes of the Center Support (G) until the center support sits in the middle of the slats.

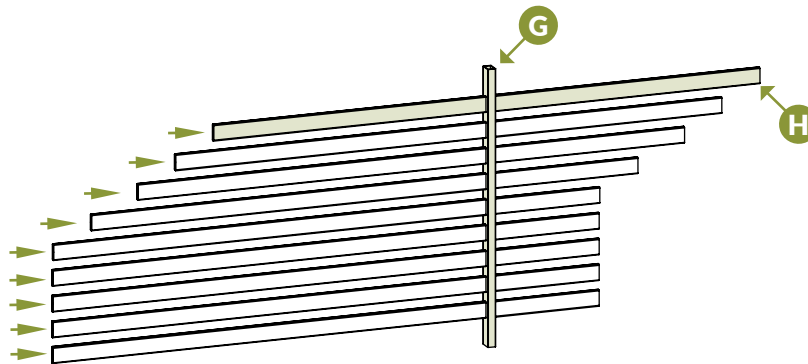

STEP 3.2 ▶

1. Slide the slats into the routed holes in one of the Posts (F).
2. Slide a second end post over the slats.

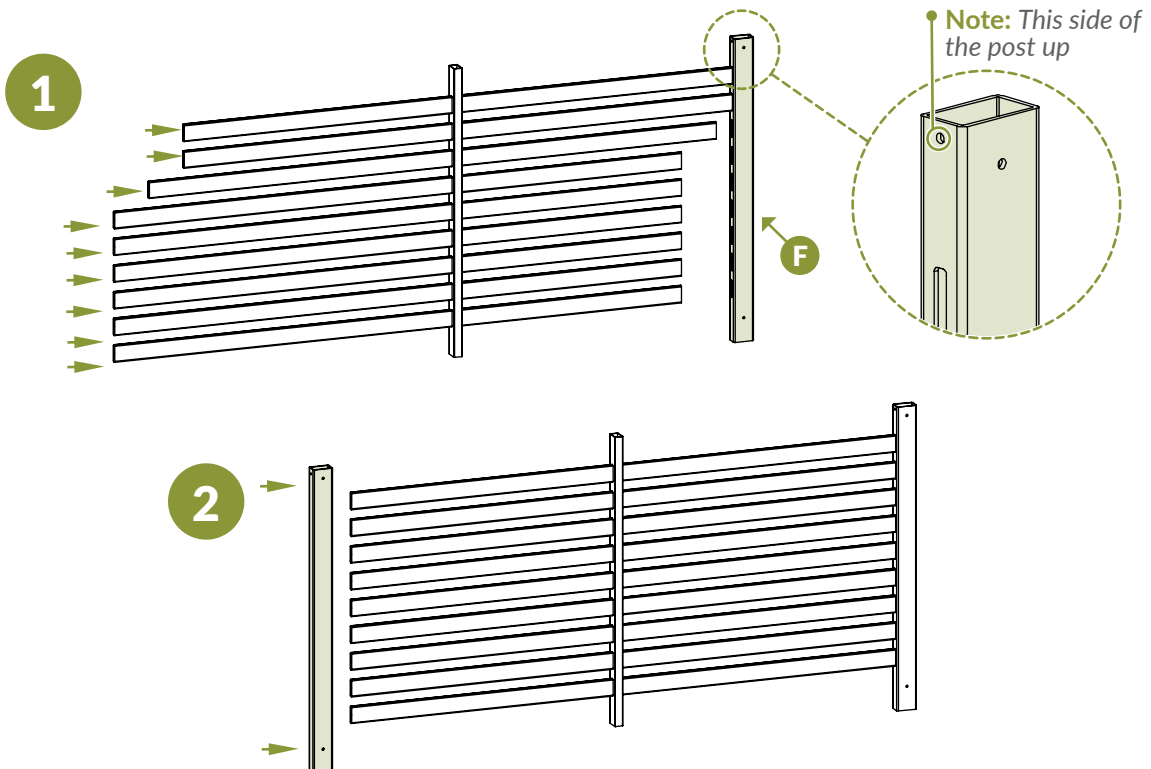

STEP 3.3

1. Identify the Top Rail (D) and the Bottom Rail (E) as shown below.
2. Insert two loose Rail End Caps (A). Make sure they are oriented as illustrated.

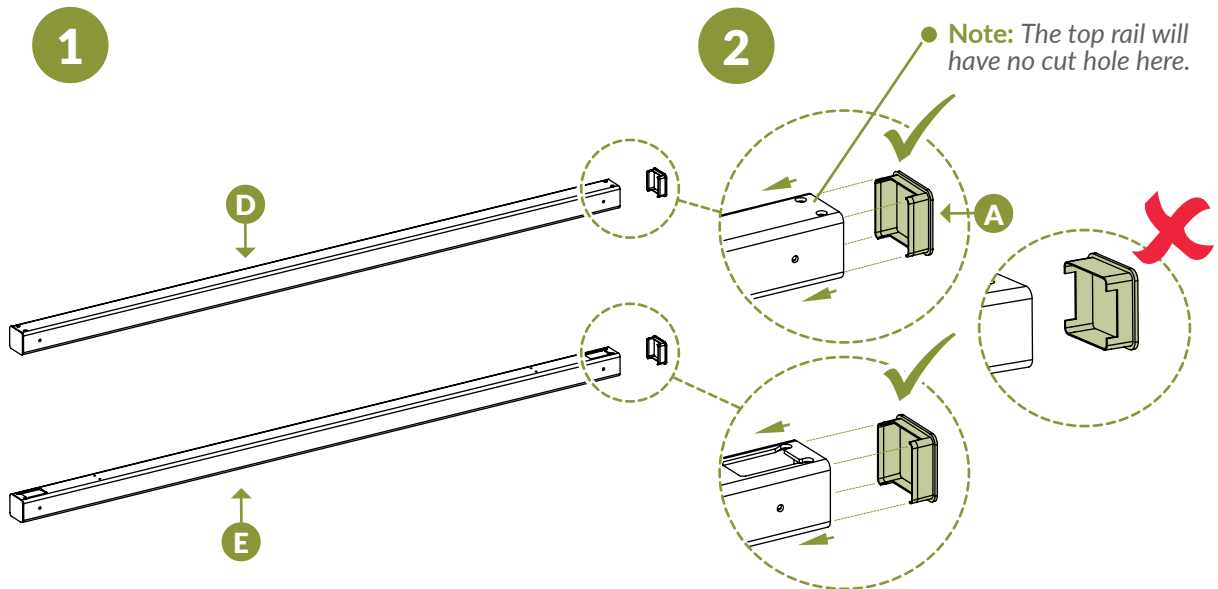
**STEP 3.4**

1. Slide the top rail over the tops of the posts until the pre-drilled holes in the posts and the top rail align.
2. Drive (2) total $\frac{3}{4}$ " Self-Drilling Stainless Steel Screws (K) into the pre-drilled holes in the top rail.

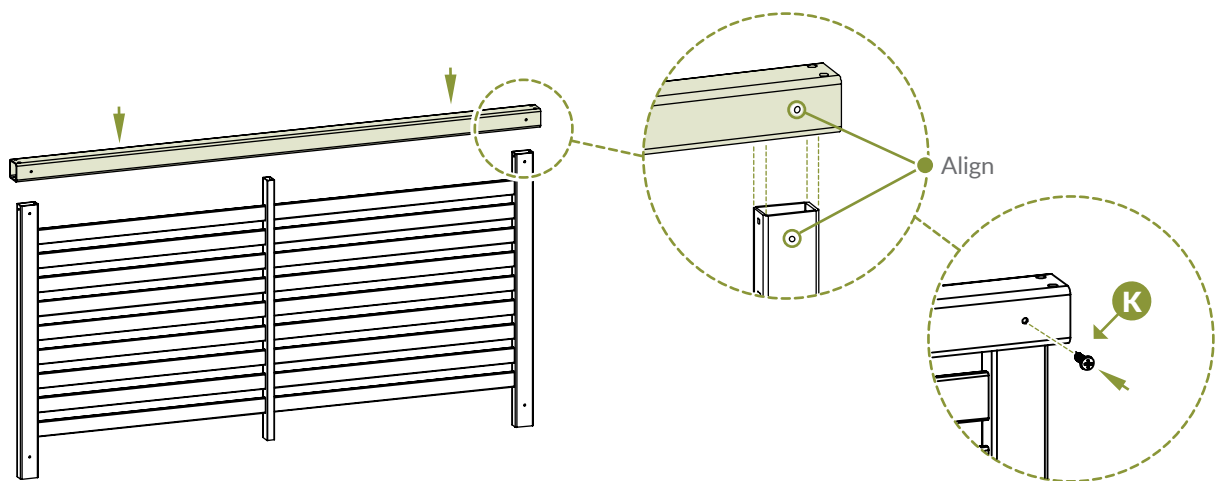

STEP 3.5 ▶

1. Slide the bottom rail over the bottoms of the posts until the pre-drilled holes in the (2) posts and the bottom rail align. Ensure the middle post inserts into the hole in the bottom rail.
2. Drive (2) total $\frac{3}{4}$ " self-drilling stainless steel screws into the pre-drilled holes in the bottom rail.

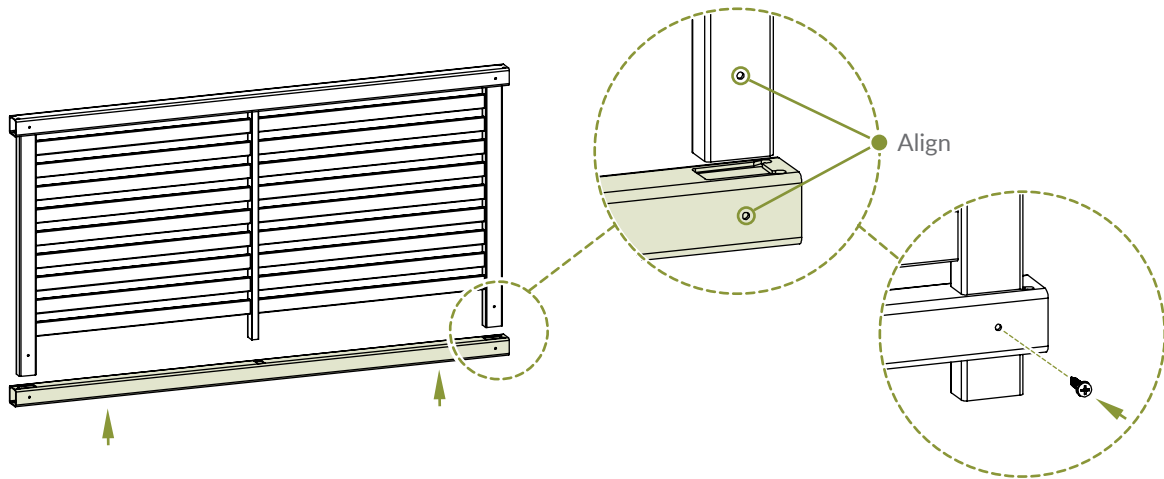
**STEP 3.6** ▶

- ▶ Turn the panel to the other side and drive (4) total $\frac{3}{4}$ " self-drilling stainless steel screws through the pre-drilled holes in the top and bottom rail.

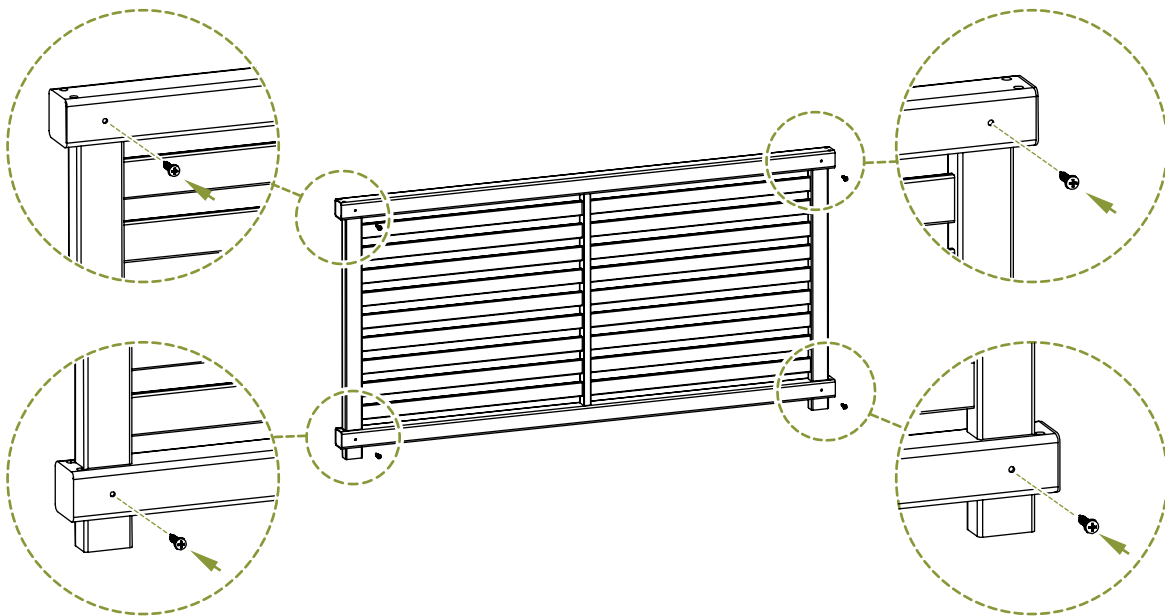

STEP 4: ATTACH THE FEET

STEP 4.1 ▶

1. Identify the Portable Feet (**B**). Set aside (4) of the Silicone No-Scratch Pads (**C**).
2. Remove the adhesive cover from the pads and stick two pads on the far ends of the underside of each foot as shown below.

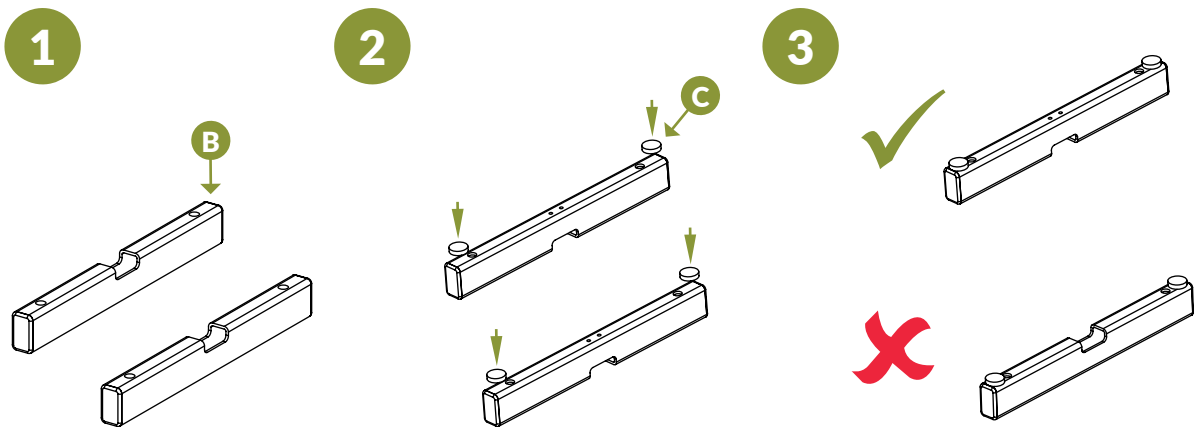

STEP 4.2 ▶

1. Take one of the portable feet and slide the notched end over the underside of the bottom rail.
2. Align the foot pre-drilled holes with the bottom rail pre-drilled holes and drive (2) 1½" Self-Drilling Stainless Steel Screws (**L**) through the pre-drilled holes in the underside of the portable foot.
3. Repeat this process on the other side of the fence panel.

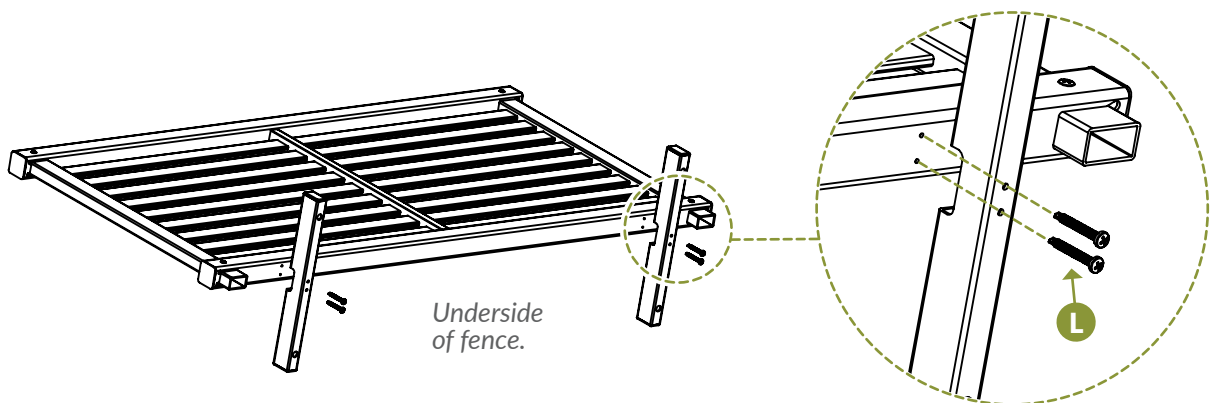

STEP 5: ASSEMBLE SECOND FENCE PANEL

STEP 5.1 ▶

- ▶ Repeat steps 3-4 to assemble the second fence panel.

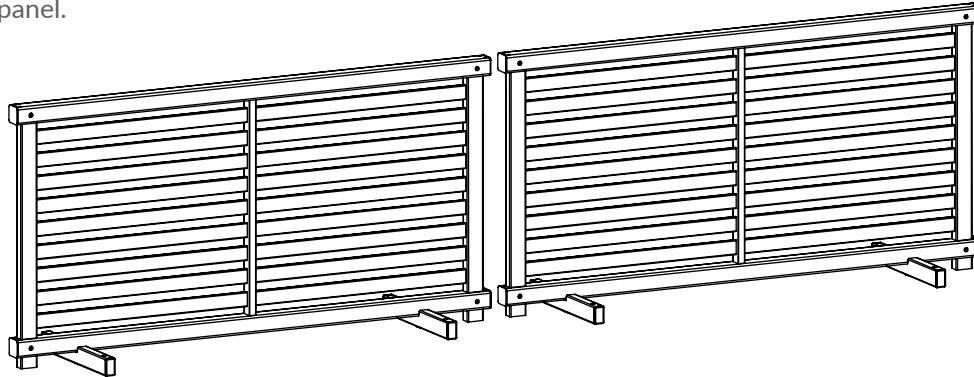

STEP 6: CONNECT THE PANELS

STEP 6.1 ▶

- ▶ Connect the two fence panels using the Connector Pins (I) as shown below.
In-Line Application:

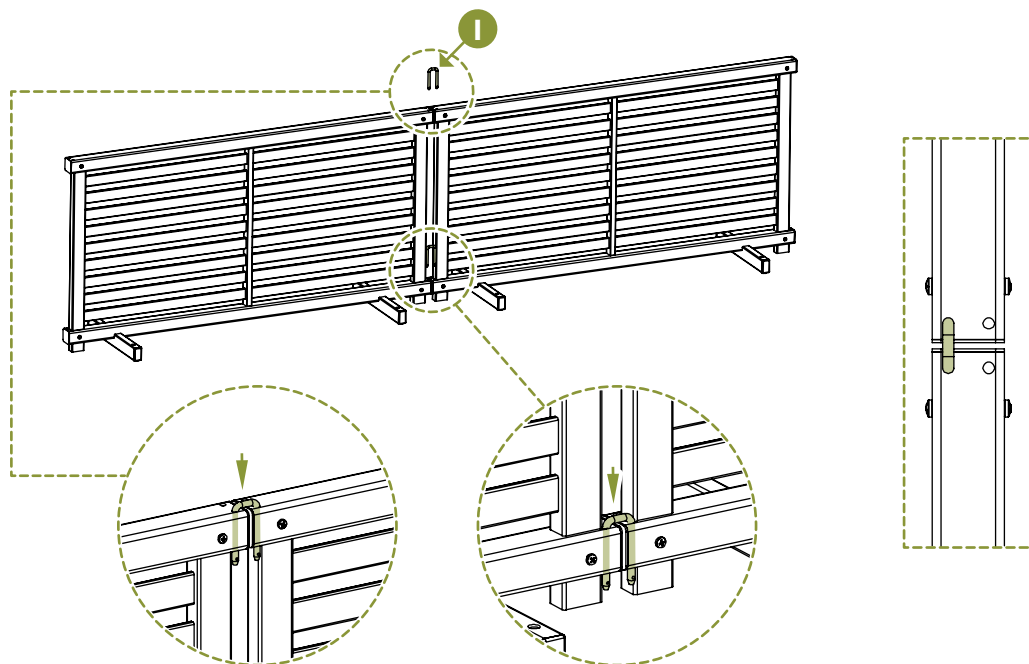

STEP 6.2 ▶

▶ Connect the two fence panels using the Connector Pins (I) as shown below.

Corner/Angled Application:

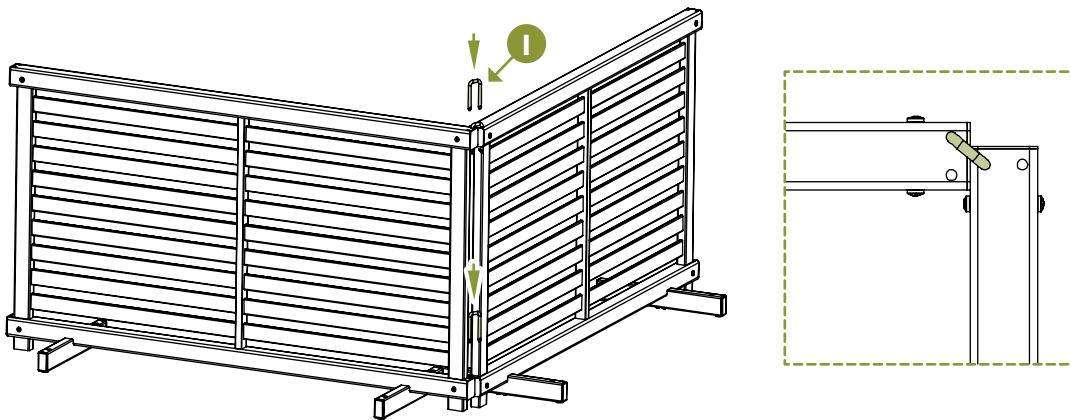
**STEP 6.3** ▶

▶ Secure the connector pins with the Locking Pin (J).

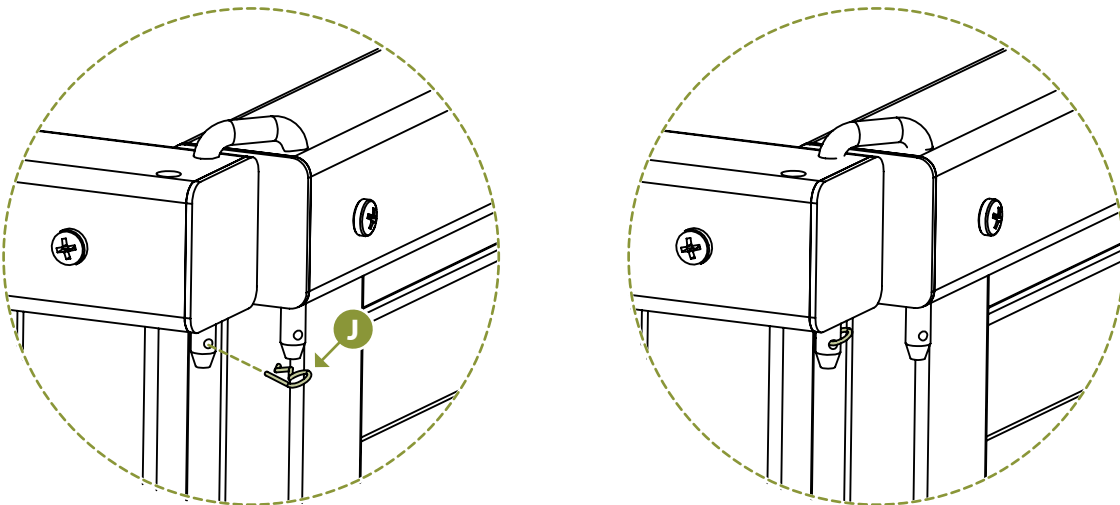



ZIPPITY

Easy Does It!



6935 Reames Rd. Ste. K.
Charlotte, NC 28216



support@zippity-outdoor.com

704-892-5222
877-234-6196



WWW.ZIPPITY-OUTDOOR.COM